



- Abutting Towns
- Water Body
- Water Line
- Wetlands
- Wetland Regulated Buffer 1
- Wetland Regulated Riverfr
- Buildings
- Master Plan - Town Bound
- Master Plan Base Map - Sr
- Parcels - For Gray Backgrc
- Highways - White
- US Route
- State Highway
- Pavement Markings
- Impervious Surface - For B
- Street
- Sidewalk
- Street Island
- Driveway
- Driveway
- Bike Path
- Roads - For Large Scale (f
- Roads - For Small Scale (f
- Major Road
- Local Road
- Master Plan Base Map - M
- Master Plan Base Map - W
- Master Plan Base Map - W
- Town Boundary - Grey Bar



The data shown on this site are provided for informational and planning purposes only. The town and its consultants are not responsible for the misuse or misrepresentation of the data.

# Wetland and Flood GIS Viewer

Printed on 12/04/2020 at 06:37 AM

144 ft

72

Adam's Quality Masonry  
53 Fairmount Ave  
Wakefield, MA 01880 US  
+1 5086417989  
adam@adamsqualitymasonry.com



## Estimate

### ADDRESS

Kathleen Moriarty

ESTIMATE # 1111-172

DATE 12/15/2020

SERVICE	DESCRIPTION	QTY	RATE	AMOUNT
<b>Masonry</b>	Excavate dirt and haul it away. Build frame and pour concrete level about 8' x 15' with 1/2 rebar	1	4,500.00	4,500.00
<b>Landscaping</b>	Brin loan in and grade yard	1	500.00	500.00

Payment Schedule  
1/2 deposit 1/2 upon completion

TOTAL

**\$5,000.00**

Fully licensed with CSL and HIC  
Fully insured

Accepted By

Accepted Date



Additional view of yard facing bike path/brook.

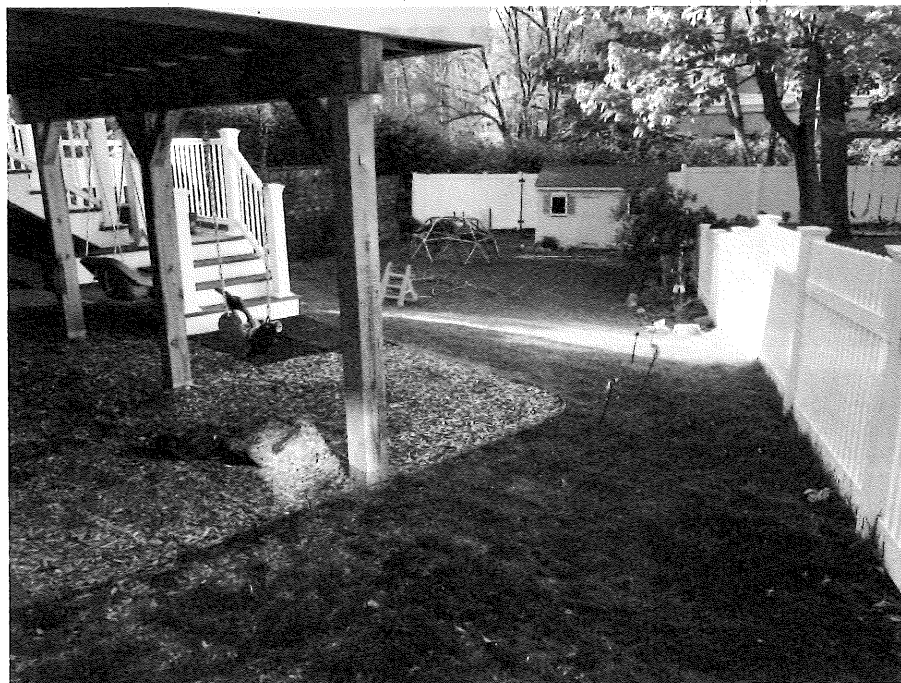

Other side of the porch from where the spa would be located.

# Challenger 15 D

Elite Performance, Airless VIP, Programmable Speed\*

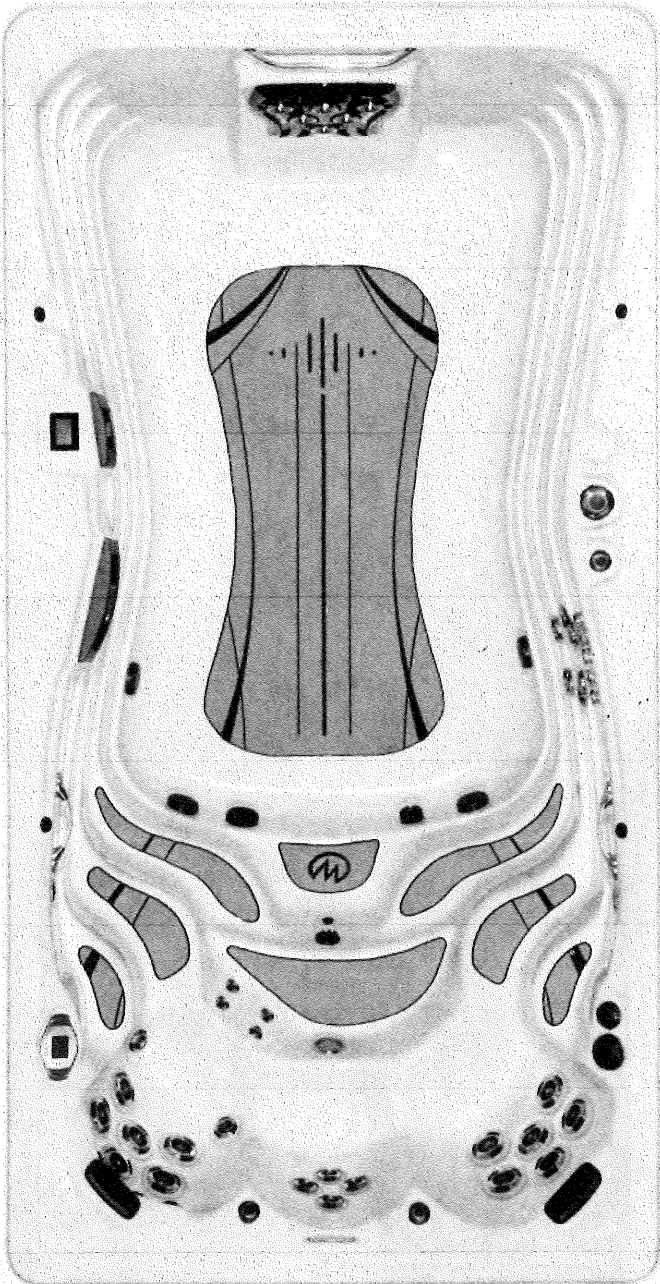

The Challenger 15 D features a large uninhibited area that is perfect for swimming, exercise, and family fun. The Airless VIP Technology enhances swim jet performance, and a variable speed system\* allows you to customize the pace. Plus, when it comes to hydrotherapy, rehabilitation, and relaxation, nothing compares to the Xtreme Therapy Seat and Xtreme Therapy Cove. The smallest footprint of any Challenger model, it's ideal for small backyards.



Dimensions	180" x 94" (457 cm x 239 cm)
Depth	60" (153 cm)
Water Capacity	1,930 Gallons (7 306 L)
Weight: Dry/Full	2,530 lbs. (1 148 kg) / 19,555 lbs. (8 870 kg)
Propulsion System	Airless VIP Technology
Power Requirement	50 Amp System
Pumps	3
Stainless Steel Jets	45 (Including 6 VIP Jets)
Water Features	5
Ozone System	Standard
Filtration	EcoPur® Charge
LED Lighting	Waterline
Exclusive Features	AquaSpeed VSP™ * StressRelief Neck and Shoulder Seat™ Master Force™ Bio-Magnetic Therapy System
Exclusive Accessories	H2Xercise™ Fitness System
Premium Options	Fusion Air Sound System Wi-Fi Module Mast3rPur™ Water Management System SoftTread™ Nonslip, Comfort Floor System by SwimDek® Wave Light Package
Listing Number	9915

\* For International Challenger swim spas, the AquaSpeed VSP system is currently not available. Instead, 3 high flow pumps create a strong, deep, and wide water current from a combination of 7 available speeds.

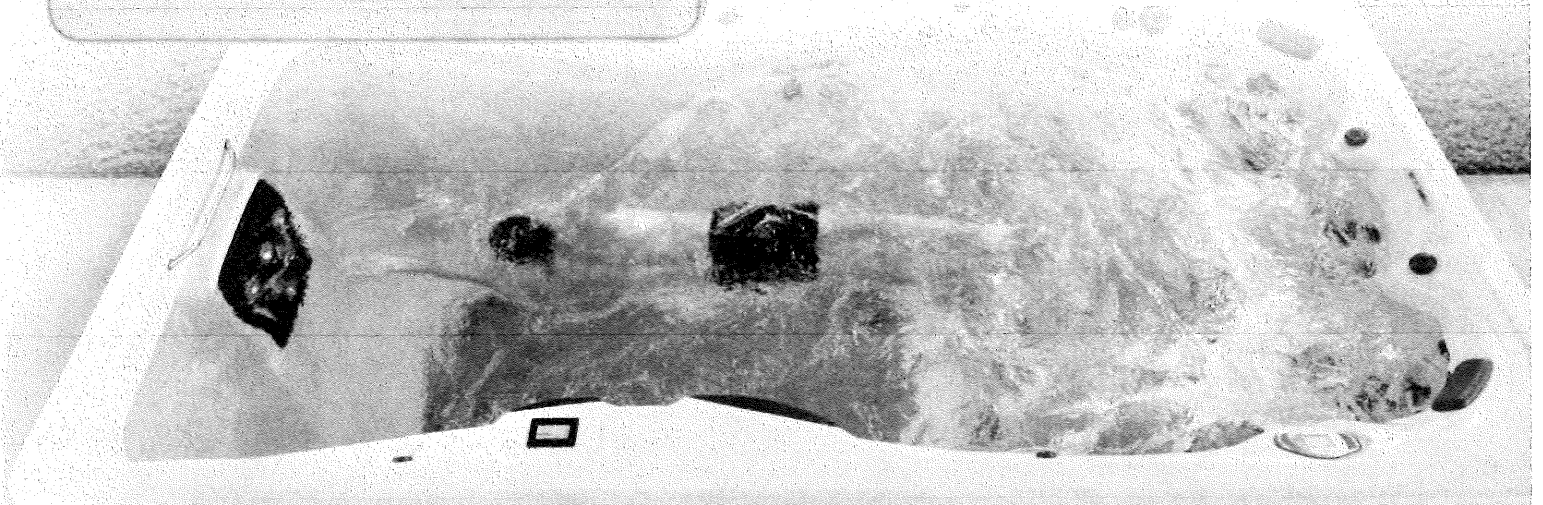

[Datasets](#) [Products](#) [Cart](#)

Select products below and then hit "Search Products"

Area of Interest:

Advanced Search

Map

- US Topo
- Historical Topographic Maps

Data

- Boundaries - National Boundary Dataset
- Elevation Products (3DEP)
- Elevation Source Data (3DEP) - Lidar, IfSAR
- Hydrography (NHDPlus HR, NHD, WBD)
- Imagery - NAIP Plus (1 meter to 1 foot)
- Map Indices
- Names - Geographic Names Information System (GNIS)
- Small-scale Datasets
- Structures - National Structures Dataset
- Topo Map Data and Topo Stylesheet
- Transportation
- Woodland Tint
- Elevation - Topobathy

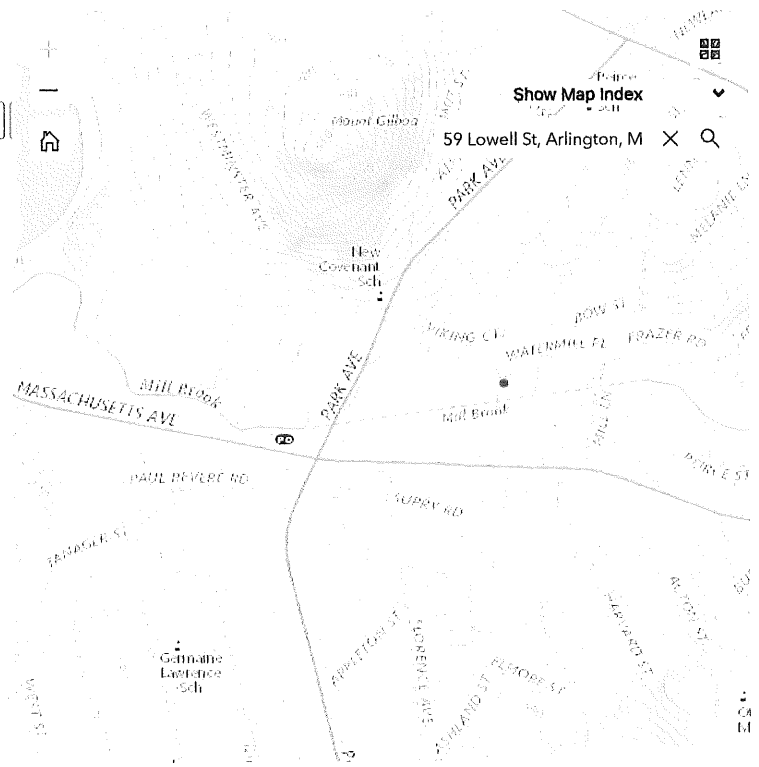

National Land Cover Database (NLCD) data can be downloaded at the MRLC website.

XY -71.187424°, 42.427486°

600 ft

NO NAME BROOK  
 (LOCATION SCALED FROM ARLINGTON GIS MAPS)

MINUTEMAN BIKEWAY  
 N 84°08'00" W

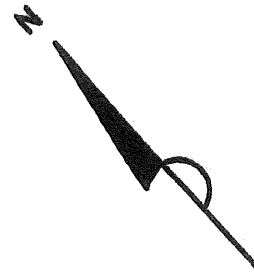

PROPOSED ABOVE-GROUND POOL  
 LOT B  
 N/F  
 THE BRIDGET M. CHANEY  
 REVOCABLE TRUST AGREEMENT

LOTS 12 & A  
 N/F  
 DANIEL & ELIZABETH CALLAHAN

LOT A  
 N/F  
 RICHARD & KATHERINE MURRAY

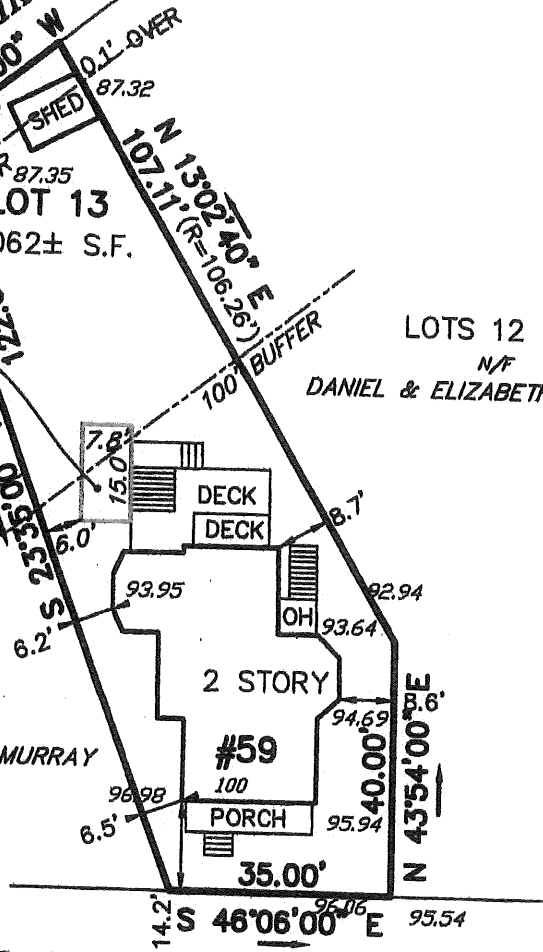

**LOWELL STREET**

I HEREBY CERTIFY THAT THE BUILDING IS  
 LOCATED AS SHOWN.

OWNER: KATHLEEN MORIARTY

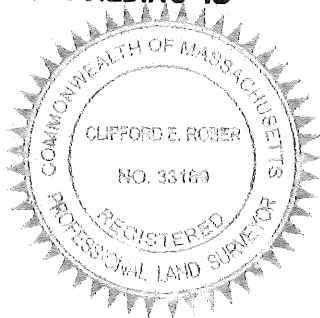

PROPOSED PLOT PLAN  
 #59 LOWELL STREET  
 IN  
 ARLINGTON, MA  
 (MIDDLESEX COUNTY)

SCALE: 1" = 30' DATE: 9/22/2020

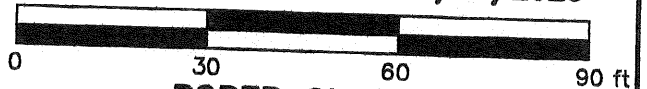

**ROBER SURVEY**

1072A MASSACHUSETTS AVENUE  
 ARLINGTON, MA 02476  
 (781) 648-5533

4542PP3.DWG

*[Signature]* 9/22/20  
 CLIFFORD E. ROBER, PLS DATE

THIS PLAN MAY HAVE BEEN ALTERED IF  
 THE SIGNATURE IS NOT SIGNED IN BLUE.



Office of the Board of Assessors  
Robbins Memorial Town Hall  
Arlington, MA 02476  
(781) 316-3050  
Assessors@town.arlington.ma.us

## Abutters List

Date: December 08, 2020

Subject Property Address: 59 LOWELL ST Arlington, MA  
Subject Property ID: 58-6-9

Search Distance: 100 Feet - Conservation

The Board of Assessors certifies the names and addresses of requested parties in interest, all abutters to a single parcel within 100 feet.

*Paul G. Feeley*  
*Robert E. Greeley*  
*[Signature]*

---

**Board of Assessors**

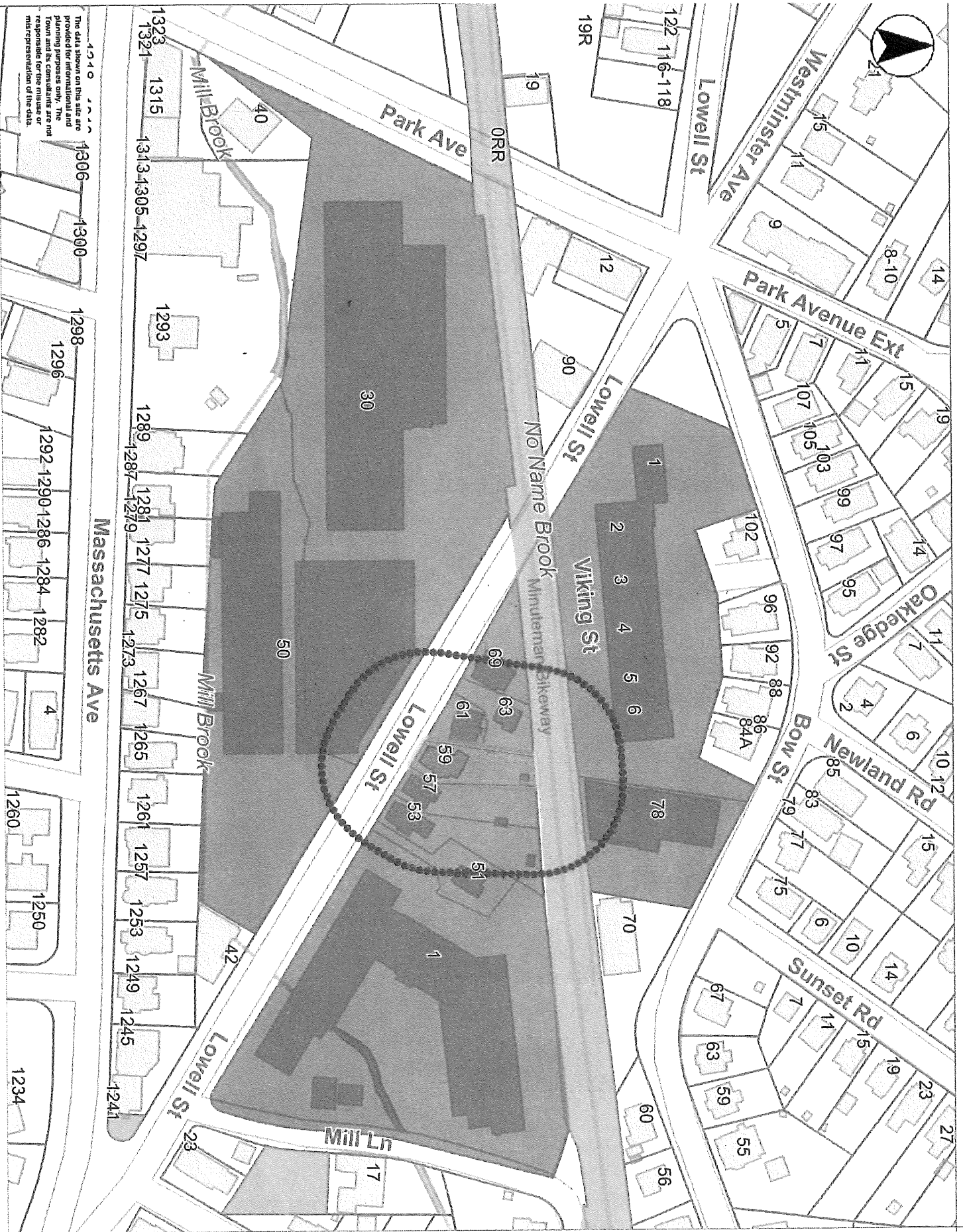

- Places by Category
  - Police Station
  - Fire Station
  - School
  - Library
  - Public Works
  - Recreation - Facilities
  - Recreation - Fields Courts
  - Recreation - Fields Courts
  - Open Space - Conservation
  - Open Space - Minuteman I
  - Open Space - Labels
- Open Space
  - Town, State, or Private
  - Other Town Owned
  - MA Highways
  - Interstate
  - US Highway
  - Numbered Routes
- Abutting Towns
- Town Boundary
- Parcels
- Buildings
- Cemetery - Roads
  - Road1
  - Road2
  - Road3
  - Road4
- Pavement Markings
- Impervious Surface - For B
  - Sidewalk
  - Street Island
  - Driveway
  - Parking Lot
  - Bike Path
- Roads - For Large Scale (f)
  - Roads - For Small Scale (f)
  - Major Road
  - Local Road
  - Master Plan Base Map - M
- Water Line
- Water Body

The data shown on this site are provided for reference only. The Town and its consultants are not responsible for the misuse or misrepresentation of the data.



Printed on 12/08/2020 at 11:43 AM



-----  
Prop ID: 58.C-1-519  
Prop Location: 1 WATERMILL PL UNIT 519 Arlington, MA  
Owner: MCSWEENEY MICHAEL & JUDITH  
Co-Owner:  
Mailing Address:  
1 WATERMILL PL #519  
ARLINGTON, MA 02476  
-----

Prop ID: 58.C-1-520  
Prop Location: 1 WATERMILL PL UNIT 520 Arlington, MA  
Owner: LEE TSENG-CHUNG ETAL /TRUSTEES  
Co-Owner: TSENG-CHUNG LEE TRUST &  
Mailing Address:  
24 FAIRLAWN LN  
LEXINGTON, MA 02420  
-----

Prop ID: 58.C-1-521  
Prop Location: 1 WATERMILL PL UNIT 521 Arlington, MA  
Owner: ONE WATERMILL PLACE LLC  
Co-Owner:  
Mailing Address:  
70 STONE ROAD  
WALTHAM, MA 02453  
-----

Prop ID: 58.C-1-522  
Prop Location: 1 WATERMILL PL UNIT 522 Arlington, MA  
Owner: GUTIERREZ SONIA  
Co-Owner:  
Mailing Address:  
1 WATERMILL PL #522  
ARLINGTON, MA 02476  
-----

Prop ID: 58.C-1-523  
Prop Location: 1 WATERMILL PL UNIT 523 Arlington, MA  
Owner: DOYLE DANIEL K  
Co-Owner:  
Mailing Address:  
25 HUCKLEBERRY HILL RD  
LINCOLN, MA 01773  
-----

Prop ID: 58.C-1-524  
Prop Location: 1 WATERMILL PL UNIT 524 Arlington, MA  
Owner: MARSHALL EDWARD & JAMIE  
Co-Owner:  
Mailing Address:  
1 WATERMILL PL #524  
ARLINGTON, MA 02476  
-----

Prop ID: 58.C-1-525  
Prop Location: 1 WATERMILL PL UNIT 525 Arlington, MA  
Owner: LYONS JACQUELINE  
Co-Owner:  
Mailing Address:  
1 WATERMILL PL #525  
ARLINGTON, MA 02476  
-----

Prop ID: 58.C-1-526  
Prop Location: 1 WATERMILL PL UNIT 526 Arlington, MA  
Owner: DOWNEY ELIZABETH  
Co-Owner:  
Mailing Address:  
1 WATERMILL PL #526  
ARLINGTON, MA 02476  
-----

-----  
Prop ID: 58.C-1-527  
Prop Location: 1 WATERMILL PL UNIT 527 Arlington, MA  
Owner: TONG ZHEN  
Co-Owner:  
Mailing Address:  
1 WATERMILL PL #527  
ARLINGTON, MA 02474  
-----

Prop ID: 58.C-1-528  
Prop Location: 1 WATERMILL PL UNIT 528 Arlington, MA  
Owner: MOHAN PASUPATHICOIL RAMASWAMY  
Co-Owner: MOHAN RADHIKA  
Mailing Address:  
1 WATERMILL PL #528  
ARLINGTON, MA 02474  
-----

Prop ID: 59-1-12  
Prop Location: 30 PARK AVE Arlington, MA  
Owner: 30 PARK AVE ASSOC LLP  
Co-Owner:  
Mailing Address:  
PO BOX 288  
ARLINGTON, MA 02476  
-----

Prop ID: 59-1-19  
Prop Location: 50 LOWELL ST Arlington, MA  
Owner: 30 PARK AVE ASSOCIATES LLC  
Co-Owner:  
Mailing Address:  
PO BOX 288  
ARLINGTON, MA 02476  
-----

Prop ID: 59-3-12.A  
Prop Location: 78 BOW ST Arlington, MA  
Owner: ZERVOGLOS ANTHONY N--ETAL  
Co-Owner: STRATKIS GEORGE  
Mailing Address:  
16 BRISCOE ST  
WOBURN, MA 01801  
-----

Prop ID: 59-3-13  
Prop Location: 67-69 LOWELL ST Arlington, MA  
Owner: KAPOOR KALPANA  
Co-Owner:  
Mailing Address:  
67 LOWELL ST  
ARLINGTON, MA 02476  
-----

Prop ID: 59-3-4.A  
Prop Location: 1-6 VIKING CT Arlington, MA  
Owner: JOHNSON SANDRA A-TR--ETAL  
Co-Owner: JOHNSON RICHARD A  
Mailing Address:  
1026 MASS AVENUE SUITE 1  
ARLINGTON, MA 02476  
-----

-----  
Prop ID: 58.C-1-430  
Prop Location: 1 WATERMILL PL UNIT 430 Arlington, MA  
Owner: BLACKSTONE BARBARA A  
Co-Owner:  
Mailing Address:  
1 WATERMILL PL #430  
ARLINGTON, MA 02476  
-----

Prop ID: 58.C-1-500  
Prop Location: 1 WATERMILL PL UNIT 500 Arlington, MA  
Owner: CAFFREY PATRICIA  
Co-Owner:  
Mailing Address:  
1 WATERMILL PL #500  
ARLINGTON, MA 02474  
-----

Prop ID: 58.C-1-501  
Prop Location: 1 WATERMILL PL UNIT 501 Arlington, MA  
Owner: DORAN MARY E  
Co-Owner:  
Mailing Address:  
1 WATERMILL PL #501  
ARLINGTON, MA 02476  
-----

Prop ID: 58.C-1-502  
Prop Location: 1 WATERMILL PL UNIT 502 Arlington, MA  
Owner: YEE NORMAN N  
Co-Owner:  
Mailing Address:  
1 WATERMILL PL #502  
ARLINGTON, MA 02476  
-----

Prop ID: 58.C-1-504  
Prop Location: 1 WATERMILL PL UNIT 504 Arlington, MA  
Owner: SO OI YIN CHEUNG  
Co-Owner:  
Mailing Address:  
21 PATTERSON RD  
LEXINGTON, MA 02421  
-----

Prop ID: 58.C-1-505  
Prop Location: 1 WATERMILL PL UNIT 505 Arlington, MA  
Owner: MARINI DONALD  
Co-Owner:  
Mailing Address:  
39 WORCESTER ST #3  
BOSTON, MA 02118  
-----

Prop ID: 58.C-1-506  
Prop Location: 1 WATERMILL PL UNIT 506 Arlington, MA  
Owner: DONNELLY TIMOTHY G  
Co-Owner:  
Mailing Address:  
1 WATERMILL PL # 506  
ARLINGTON, MA 02476  
-----

Prop ID: 58.C-1-507  
Prop Location: 1 WATERMILL PL UNIT 507 Arlington, MA  
Owner: LYLE JAMES E  
Co-Owner:  
Mailing Address:  
1 WATERMILL PL #507  
ARLINGTON, MA 02476  
-----

-----  
Prop ID: 58.C-1-508  
Prop Location: 1 WATERMILL PL UNIT 508 Arlington, MA  
Owner: PATEL ALRIK  
Co-Owner:  
Mailing Address:  
1 WATERMILL PL APT 508  
ARLINGTON, MA 02476  
-----

Prop ID: 58.C-1-509  
Prop Location: 1 WATERMILL PL UNIT 509 Arlington, MA  
Owner: LUDWIG SUSAN B/TRUSTEE  
Co-Owner: SUSAN B LUDWIG LIVING TRUST  
Mailing Address:  
1 WATERMILL PL #509  
ARLINGTON, MA 02476  
-----

Prop ID: 58.C-1-510  
Prop Location: 1 WATERMILL PL UNIT 510 Arlington, MA  
Owner: METALLIDES CYNTHIA/TRUSTEE  
Co-Owner: 1 WATERMILL PLACE UNIT 510  
Mailing Address:  
1 WATERMILL PL #510  
ARLINGTON, MA 02476  
-----

Prop ID: 58.C-1-512  
Prop Location: 1 WATERMILL PL UNIT 512 Arlington, MA  
Owner: FENDELANDER LAHN M  
Co-Owner:  
Mailing Address:  
88 BUSH ST  
UNIT 4114  
SAN JOSE, CA 95126  
-----

Prop ID: 58.C-1-514  
Prop Location: 1 WATERMILL PL UNIT 514 Arlington, MA  
Owner: O REGAN LYNNE A  
Co-Owner:  
Mailing Address:  
1 WATERMILL PL #514  
ARLINGTON, MA 02476  
-----

Prop ID: 58.C-1-516  
Prop Location: 1 WATERMILL PL UNIT 516 Arlington, MA  
Owner: GARDINI ORNELLA  
Co-Owner:  
Mailing Address:  
1 WATERMILL PL #516  
ARLINGTON, MA 02476  
-----

Prop ID: 58.C-1-517  
Prop Location: 1 WATERMILL PL UNIT 517 Arlington, MA  
Owner: MARVIT MARIAN  
Co-Owner:  
Mailing Address:  
1 WATERMILL PL #517  
ARLINGTON, MA 02476  
-----

Prop ID: 58.C-1-518  
Prop Location: 1 WATERMILL PL UNIT 518 Arlington, MA  
Owner: FLEMING ROBERT P  
Co-Owner: MASSARO MARK  
Mailing Address:  
1 WATERMILL PL #518  
ARLINGTON, MA 02476  
-----

-----  
Prop ID: 58.C-1-410  
Prop Location: 1 WATERMILL PL UNIT 410 Arlington, MA  
Owner: FLAMM BARRY E  
Co-Owner:  
Mailing Address:  
1 WATERMILL PL #410  
ARLINGTON, MA 02476  
-----

Prop ID: 58.C-1-412  
Prop Location: 1 WATERMILL PL UNIT 412 Arlington, MA  
Owner: JOYCE MARY TARA  
Co-Owner:  
Mailing Address:  
675 LAKE ST APT 223  
OAK PARK, IL 60301  
-----

Prop ID: 58.C-1-414  
Prop Location: 1 WATERMILL PL UNIT 414 Arlington, MA  
Owner: LYNCH RICHARD T  
Co-Owner:  
Mailing Address:  
1 WATERMILL PL #414  
ARLINGTON, MA 02476  
-----

Prop ID: 58.C-1-415  
Prop Location: 1 WATERMILL PL UNIT 415 Arlington, MA  
Owner: MORELAND RHOMANCE E TRUSTEE  
Co-Owner: REM REALTY TRUST  
Mailing Address:  
1 WATERMILL PL #415  
ARLINGTON, MA 02476  
-----

Prop ID: 58.C-1-416  
Prop Location: 1 WATERMILL PL UNIT 416 Arlington, MA  
Owner: BOUDREAU LORRAINE  
Co-Owner:  
Mailing Address:  
1 WATERMILL PL #416  
ARLINGTON, MA 02474  
-----

Prop ID: 58.C-1-417  
Prop Location: 1 WATERMILL PL UNIT 417 Arlington, MA  
Owner: PRENDERGAST MICHAEL D ETAL  
Co-Owner: TRS/ PRENDERGAST FAMILY TRUST  
Mailing Address:  
785 S GAYLORD ST  
DENVER, CO 80209-4629  
-----

Prop ID: 58.C-1-418  
Prop Location: 1 WATERMILL PL UNIT 418 Arlington, MA  
Owner: MC DERMOTT MARIAN D  
Co-Owner:  
Mailing Address:  
1 WATERMILL PL #418  
ARLINGTON, MA 02476  
-----

Prop ID: 58.C-1-419  
Prop Location: 1 WATERMILL PL UNIT 419 Arlington, MA  
Owner: TOSTI ALLAN & BARBARA A  
Co-Owner:  
Mailing Address:  
1 WATERMILL PL #419  
ARLINGTON, MA 02476  
-----

-----  
Prop ID: 58.C-1-420  
Prop Location: 1 WATERMILL PL UNIT 420 Arlington, MA  
Owner: KIM DAVID E TRUSTEE  
Co-Owner: PARK CHRISTINE H TRUSTEE  
Mailing Address:  
28631 BRECKENRIDGE DRIVE  
LAGUNA NIGUEL, CA 92677  
-----

Prop ID: 58.C-1-421  
Prop Location: 1 WATERMILL PL UNIT 421 Arlington, MA  
Owner: JABR REEM Z  
Co-Owner:  
Mailing Address:  
1 WATERMILL PL # 421  
ARLINGTON, MA 02476  
-----

Prop ID: 58.C-1-423  
Prop Location: 1 WATERMILL PL UNIT 423 Arlington, MA  
Owner: SCHNEIDER MARJORIE L  
Co-Owner:  
Mailing Address:  
1 WATERMILL PL #423  
ARLINGTON, MA 02476  
-----

Prop ID: 58.C-1-424  
Prop Location: 1 WATERMILL PL UNIT 424 Arlington, MA  
Owner: LIN YAN-TING  
Co-Owner: CHEN YIAN  
Mailing Address:  
1 WATERMILL PL UNIT 424  
ARLINGTON, MA 02476  
-----

Prop ID: 58.C-1-425  
Prop Location: 1 WATERMILL PL UNIT 425 Arlington, MA  
Owner: STACK MARY  
Co-Owner: HOCHMUTH CHARLES  
Mailing Address:  
16 LOCKE ST  
ARLINGTON, MA 02476  
-----

Prop ID: 58.C-1-426  
Prop Location: 1 WATERMILL PL UNIT 426 Arlington, MA  
Owner: GOPALAN MADHAVAN S  
Co-Owner:  
Mailing Address:  
3104 ARGENT PATH  
ELLCOTT CITY, MD 21043  
-----

Prop ID: 58.C-1-427  
Prop Location: 1 WATERMILL PL UNIT 427 Arlington, MA  
Owner: GERSHMAN RACHEL E  
Co-Owner:  
Mailing Address:  
1 WATERMILL PL #427  
ARLINGTON, MA 02476  
-----

Prop ID: 58.C-1-428  
Prop Location: 1 WATERMILL PL UNIT 428 Arlington, MA  
Owner: OLSZEWSKI ANGELA M  
Co-Owner:  
Mailing Address:  
1 WATERMILL PL #428  
ARLINGTON, MA 02476  
-----

-----  
Prop ID: 58.C-1-320  
Prop Location: 1 WATERMILL PL UNIT 320 Arlington, MA  
Owner: HENIZE BEATRIX  
Co-Owner:  
Mailing Address:  
1 WATERMILL PL #320  
ARLINGTON, MA 02476  
-----

Prop ID: 58.C-1-321  
Prop Location: 1 WATERMILL PL UNIT 321 Arlington, MA  
Owner: KARGER EVA R  
Co-Owner:  
Mailing Address:  
1 WATERMILL PL #321  
ARLINGTON, MA 02476  
-----

Prop ID: 58.C-1-322  
Prop Location: 1 WATERMILL PL UNIT 322 Arlington, MA  
Owner: GRIFFIN BONNIE M  
Co-Owner:  
Mailing Address:  
1 WATERMILL PL #322  
ARLINGTON, MA 02476  
-----

Prop ID: 58.C-1-323  
Prop Location: 1 WATERMILL PL UNIT 323 Arlington, MA  
Owner: LEFEBVRE LEONARD S  
Co-Owner:  
Mailing Address:  
1 WATERMILL PL #323  
ARLINGTON, MA 02476  
-----

Prop ID: 58.C-1-324  
Prop Location: 1 WATERMILL PL UNIT 324 Arlington, MA  
Owner: WHALEN FRANCIS T  
Co-Owner:  
Mailing Address:  
1 WATERMILL PL #324  
ARLINGTON, MA 02476  
-----

Prop ID: 58.C-1-325  
Prop Location: 1 WATERMILL PL UNIT 325 Arlington, MA  
Owner: MAKKI SALMAN MUHYEDIN ETAL  
Co-Owner: TRS/ MAKKIS LIVING TRUST  
Mailing Address:  
347 CALLE PUEBLO  
SAN CLEMENTE, CA 92672  
-----

Prop ID: 58.C-1-326  
Prop Location: 1 WATERMILL PL UNIT 326 Arlington, MA  
Owner: MOJAHED SHAHRIYAR  
Co-Owner:  
Mailing Address:  
8 THORNBERRY RD  
WINCHESTER, MA 01890  
-----

Prop ID: 58.C-1-328  
Prop Location: 1 WATERMILL PL UNIT 328 Arlington, MA  
Owner: BUSA DARLENE A  
Co-Owner:  
Mailing Address:  
1 WATERMILL PL #328  
ARLINGTON, MA 02476  
-----

-----  
Prop ID: 58.C-1-330  
Prop Location: 1 WATERMILL PL UNIT 330 Arlington, MA  
Owner: SULLIVAN TERRANCE  
Co-Owner:  
Mailing Address:  
1 WATERMILL PL #330  
ARLINGTON, MA 02476  
-----

Prop ID: 58.C-1-401  
Prop Location: 1 WATERMILL PL UNIT 401 Arlington, MA  
Owner: SERADERIAN VATCHE  
Co-Owner:  
Mailing Address:  
1 SCHOOLHOUSE LN  
LEXINGTON, MA 02421  
-----

Prop ID: 58.C-1-402  
Prop Location: 1 WATERMILL PL UNIT 402 Arlington, MA  
Owner: FEHLAN MAUREEN E  
Co-Owner:  
Mailing Address:  
1 WATERMILL PL #402  
ARLINGTON, MA 02476  
-----

Prop ID: 58.C-1-404  
Prop Location: 1 WATERMILL PL UNIT 404 Arlington, MA  
Owner: MATSUI HISAKO  
Co-Owner:  
Mailing Address:  
1 WATERMILL PL #404  
ARLINGTON, MA 02476  
-----

Prop ID: 58.C-1-405  
Prop Location: 1 WATERMILL PL UNIT 405 Arlington, MA  
Owner: ODONNELL LORRAINE  
Co-Owner:  
Mailing Address:  
1 WATERMILL PL #405  
ARLINGTON, MA 02476  
-----

Prop ID: 58.C-1-406  
Prop Location: 1 WATERMILL PL UNIT 406 Arlington, MA  
Owner: LIARDONI ALBERT L  
Co-Owner:  
Mailing Address:  
1 WATERMILL PL #406  
ARLINGTON, MA 02476  
-----

Prop ID: 58.C-1-407  
Prop Location: 1 WATERMILL PL UNIT 407 Arlington, MA  
Owner: OSOFSKY DAVID  
Co-Owner:  
Mailing Address:  
1 WATERMILL PL #407  
ARLINGTON, MA 02476  
-----

Prop ID: 58.C-1-409  
Prop Location: 1 WATERMILL PL UNIT 409 Arlington, MA  
Owner: ZASLAVSKY PAUL/ LIFE ESTATE  
Co-Owner: SHPIRT ANNA/ LIFE ESTATE  
Mailing Address:  
1 WATERMILL PL #409  
ARLINGTON, MA 02476  
-----

-----  
Prop ID: 58.C-1-302  
Prop Location: 1 WATERMILL PL UNIT 302 Arlington, MA  
Owner: HOCHMUTH CHARLES H  
Co-Owner: STACK MARY G  
Mailing Address:  
16 LOCKE ST  
ARLINGTON, MA 02476  
-----

Prop ID: 58.C-1-304  
Prop Location: 1 WATERMILL PL UNIT 304 Arlington, MA  
Owner: TOBIN ALICE P  
Co-Owner:  
Mailing Address:  
1 WATERMILL PL  
UNIT 304  
ARLINGTON, MA 02476  
-----

Prop ID: 58.C-1-305  
Prop Location: 1 WATERMILL PL UNIT 305 Arlington, MA  
Owner: BUSH ARTHUR H/ TRUSTEE  
Co-Owner: ARTHUR H BUSH TRUST  
Mailing Address:  
1 WATERMILL PL #305  
ARLINGTON, MA 02476  
-----

Prop ID: 58.C-1-306  
Prop Location: 1 WATERMILL PL UNIT 306 Arlington, MA  
Owner: LENNOX MIRIAN C  
Co-Owner: WORTHINGTON ANNABEL S  
Mailing Address:  
1 WATERMILL PL #306  
ARLINGTON, MA 02476  
-----

Prop ID: 58.C-1-307  
Prop Location: 1 WATERMILL PL UNIT 307 Arlington, MA  
Owner: GAVIN TERRI M  
Co-Owner:  
Mailing Address:  
1 WATERMILL PL #307  
ARLINGTON, MA 02476  
-----

Prop ID: 58.C-1-308  
Prop Location: 1 WATERMILL PL UNIT 308 Arlington, MA  
Owner: PETERSON JORDAN G  
Co-Owner:  
Mailing Address:  
1 WATERMILL PL UNIT 308  
ARLINGTON, MA 02476  
-----

Prop ID: 58.C-1-309  
Prop Location: 1 WATERMILL PL UNIT 309 Arlington, MA  
Owner: PRESSMAN PEGGY E  
Co-Owner:  
Mailing Address:  
1 WATERMILL PL #309  
ARLINGTON, MA 02476  
-----

Prop ID: 58.C-1-310  
Prop Location: 1 WATERMILL PL UNIT 310 Arlington, MA  
Owner: LERMAN SCOTT M  
Co-Owner:  
Mailing Address:  
1 WATERMILL PL #310  
ARLINGTON, MA 02476  
-----

-----  
Prop ID: 58.C-1-311  
Prop Location: 1 WATERMILL PL UNIT 311 Arlington, MA  
Owner: BACZKOWSKI DANIEL & ROSEMARIE  
Co-Owner:  
Mailing Address:  
1 WATERMILL PL #311  
ARLINGTON, MA 02476  
-----

Prop ID: 58.C-1-312  
Prop Location: 1 WATERMILL PL UNIT 312 Arlington, MA  
Owner: BOYLE BARBARA  
Co-Owner:  
Mailing Address:  
109 GRAY STREET  
ARLINGTON, MA 02476  
-----

Prop ID: 58.C-1-314  
Prop Location: 1 WATERMILL PL UNIT 314 Arlington, MA  
Owner: QUIGLEY MARY A  
Co-Owner:  
Mailing Address:  
1 WATERMILL PL #314  
ARLINGTON, MA 02476  
-----

Prop ID: 58.C-1-315  
Prop Location: 1 WATERMILL PL UNIT 315 Arlington, MA  
Owner: OREILLY PETER J  
Co-Owner:  
Mailing Address:  
1 WATERMILL PL #315  
ARLINGTON, MA 02476  
-----

Prop ID: 58.C-1-316  
Prop Location: 1 WATERMILL PL UNIT 316 Arlington, MA  
Owner: FISHER CHRISTINA/ TRUSTEE  
Co-Owner: ANNE M DIMAURO IRREVOCABLE TR  
Mailing Address:  
1 WATERMILL PL #316  
ARLINGTON, MA 02476  
-----

Prop ID: 58.C-1-317  
Prop Location: 1 WATERMILL PL UNIT 317 Arlington, MA  
Owner: SINGER BETH  
Co-Owner:  
Mailing Address:  
1 WATERMILL PL #317  
ARLINGTON, MA 02476  
-----

Prop ID: 58.C-1-318  
Prop Location: 1 WATERMILL PL UNIT 318 Arlington, MA  
Owner: COOK MELISSA K  
Co-Owner:  
Mailing Address:  
1 WATERMILL PL #318  
ARLINGTON, MA 02476  
-----

Prop ID: 58.C-1-319  
Prop Location: 1 WATERMILL PL UNIT 319 Arlington, MA  
Owner: KEELER MARY L  
Co-Owner:  
Mailing Address:  
95 CLARKS FARM RD  
CARLISLE, MA 01741  
-----

-----  
Prop ID: 58.C-1-215  
Prop Location: 1 WATERMILL PL UNIT 215 Arlington, MA  
Owner: FREINER KENNETH OLIVER JR  
Co-Owner: FREINER HOLLY T  
Mailing Address:  
1 WATERMILL PL #215  
ARLINGTON, MA 02474  
-----

Prop ID: 58.C-1-216  
Prop Location: 1 WATERMILL PL UNIT 216 Arlington, MA  
Owner: SCHRAMM ALLAN N & MARGARET  
Co-Owner:  
Mailing Address:  
1 WATERMILL PL #216  
ARLINGTON, MA 02476  
-----

Prop ID: 58.C-1-217  
Prop Location: 1 WATERMILL PL UNIT 217 Arlington, MA  
Owner: LAPORTA CARMEN G  
Co-Owner: LAPORTA MONAGHAN JOAN  
Mailing Address:  
1 WATERMILL PL #217  
ARLINGTON, MA 02476  
-----

Prop ID: 58.C-1-218  
Prop Location: 1 WATERMILL PL UNIT 218 Arlington, MA  
Owner: VOZZELLA EMMA L  
Co-Owner:  
Mailing Address:  
1 WATERMILL PL #218  
ARLINGTON, MA 02476  
-----

Prop ID: 58.C-1-219  
Prop Location: 1 WATERMILL PL UNIT 219 Arlington, MA  
Owner: GAVRILLES BESSIE  
Co-Owner: LIFE ESTATE  
Mailing Address:  
1 WATERMILL PL #219  
ARLINGTON, MA 02476  
-----

Prop ID: 58.C-1-220  
Prop Location: 1 WATERMILL PL UNIT 220 Arlington, MA  
Owner: BUNTROCK REBECCA M/TRUSTEE  
Co-Owner: MARK BUNTROCK REALTY TRUST  
Mailing Address:  
1 WATERMILL PL #220  
ARLINGTON, MA 02476  
-----

Prop ID: 58.C-1-221  
Prop Location: 1 WATERMILL PL UNIT 221 Arlington, MA  
Owner: LIEPKALNS ERIKA A  
Co-Owner:  
Mailing Address:  
1 WATERMILL PL #221  
ARLINGTON, MA 02476  
-----

Prop ID: 58.C-1-222  
Prop Location: 1 WATERMILL PL UNIT 222 Arlington, MA  
Owner: PATKI ABHAY H  
Co-Owner:  
Mailing Address:  
1 WATERMILL PL #222  
ARLINGTON, MA 02476  
-----

-----  
Prop ID: 58.C-1-223  
Prop Location: 1 WATERMILL PL UNIT 223 Arlington, MA  
Owner: CHAO ALAN I  
Co-Owner:  
Mailing Address:  
1 WATERMILL PL #223  
ARLINGTON, MA 02476  
-----

Prop ID: 58.C-1-224  
Prop Location: 1 WATERMILL PL UNIT 224 Arlington, MA  
Owner: BEAUCHESNE DIANE L  
Co-Owner:  
Mailing Address:  
219 LOWELL ST  
METHUEN, MA 01844  
-----

Prop ID: 58.C-1-225  
Prop Location: 1 WATERMILL PL UNIT 225 Arlington, MA  
Owner: MENSAH ROBERT D  
Co-Owner:  
Mailing Address:  
1 WATERMILL PL #225  
ARLINGTON, MA 02476  
-----

Prop ID: 58.C-1-226  
Prop Location: 1 WATERMILL PL UNIT 226 Arlington, MA  
Owner: UCCELLO MICHAEL  
Co-Owner:  
Mailing Address:  
1 WATERMILL PL #226  
ARLINGTON, MA 02476  
-----

Prop ID: 58.C-1-228  
Prop Location: 1 WATERMILL PL UNIT 228 Arlington, MA  
Owner: SILVA THERESA/ TRUSTEE  
Co-Owner: THERESA SILVA FAMILY TRUST  
Mailing Address:  
1 WATERMILL PL #228  
ARLINGTON, MA 02476  
-----

Prop ID: 58.C-1-230  
Prop Location: 1 WATERMILL PL UNIT 230 Arlington, MA  
Owner: HARTIG DAVID  
Co-Owner:  
Mailing Address:  
1 WATERMILL PL UNIT 230  
ARLINGTON, MA 02474  
-----

Prop ID: 58.C-1-3  
Prop Location: 1 WATERMILL PL UNIT 3 Arlington, MA  
Owner: BRADLEY VINCENT  
Co-Owner:  
Mailing Address:  
1 WATERMILL PL #3  
ARLINGTON, MA 02476  
-----

Prop ID: 58.C-1-301  
Prop Location: 1 WATERMILL PL UNIT 301 Arlington, MA  
Owner: BILOW YAKOV  
Co-Owner:  
Mailing Address:  
1 WATERMILL PL #301  
ARLINGTON, MA 02476  
-----

-----  
Prop ID: 58.C-1-126  
Prop Location: 1 WATERMILL PL UNIT 126 Arlington, MA  
Owner: MIGAUSKY MARJORIE R  
Co-Owner:  
Mailing Address:  
1 WATERMILL PL #126  
ARLINGTON, MA 02476  
-----

Prop ID: 58.C-1-128  
Prop Location: 1 WATERMILL PL UNIT 128 Arlington, MA  
Owner: MCKENZIE J STEWART & RICKI L/  
Co-Owner: TRS/ MCKENZIE REVOCABLE TRUST  
Mailing Address:  
81 WILLOW AVE  
SOMERVILLE, MA 02144  
-----

Prop ID: 58.C-1-130  
Prop Location: 1 WATERMILL PL UNIT 130 Arlington, MA  
Owner: STANLEY STEPHANIE M & WILLIAM  
Co-Owner:  
Mailing Address:  
1 WATERMILL PL #130  
ARLINGTON, MA 02476  
-----

Prop ID: 58.C-1-2  
Prop Location: 1 WATERMILL PL UNIT 2 Arlington, MA  
Owner: O SULLIVAN COLIN/KATHERINE R  
Co-Owner:  
Mailing Address:  
1 WATERMILL PL #2  
ARLINGTON, MA 02476  
-----

Prop ID: 58.C-1-201  
Prop Location: 1 WATERMILL PL UNIT 201 Arlington, MA  
Owner: COCONCEA PHILIP  
Co-Owner: DAVIDSON CHARLOTTE  
Mailing Address:  
1 WATERMILL PL #201  
ARLINGTON, MA 02476  
-----

Prop ID: 58.C-1-202  
Prop Location: 1 WATERMILL PL UNIT 202 Arlington, MA  
Owner: D SOUZA ERIC B/ TRUSTEE  
Co-Owner: ERIC B D SOUZA 2011 REVOCABLE  
Mailing Address:  
80 RUBLEE STREET  
ARLINGTON, MA 02476  
-----

Prop ID: 58.C-1-204  
Prop Location: 1 WATERMILL PL UNIT 204 Arlington, MA  
Owner: FRATIC JOSEPH JR  
Co-Owner:  
Mailing Address:  
1 WATERMILL PL #204  
ARLINGTON, MA 02474  
-----

Prop ID: 58.C-1-205  
Prop Location: 1 WATERMILL PL UNIT 205 Arlington, MA  
Owner: GIBBONS JOAN F/TRUSTEE  
Co-Owner: JOAN F GIBBONS REVOCABLE TRUST  
Mailing Address:  
1 WATERMILL PL #205  
ARLINGTON, MA 02476  
-----

-----  
Prop ID: 58.C-1-206  
Prop Location: 1 WATERMILL PL UNIT 206 Arlington, MA  
Owner: NARASIMHAN KAMALA  
Co-Owner:  
Mailing Address:  
31 CHATHAM STREET  
ARLINGTON, MA 02476  
-----

Prop ID: 58.C-1-207  
Prop Location: 1 WATERMILL PL UNIT 207 Arlington, MA  
Owner: DUBE CATHERINE/ TRUSTEE  
Co-Owner: DUBE LIVING TRUST  
Mailing Address:  
1 WATERMILL PL #207  
ARLINGTON, MA 02476  
-----

Prop ID: 58.C-1-208  
Prop Location: 1 WATERMILL PL UNIT 208 Arlington, MA  
Owner: WINSTON JENNIFER L  
Co-Owner:  
Mailing Address:  
1 WATERMILL PL #208  
ARLINGTON, MA 02476  
-----

Prop ID: 58.C-1-209  
Prop Location: 1 WATERMILL PL UNIT 209 Arlington, MA  
Owner: UCCELLO PAUL & MICHAEL/TRS  
Co-Owner: WALNUT TERRACE PROPERTY TRUST  
Mailing Address:  
1 WATERMILL PL 209  
ARLINGTON, MA 02474  
-----

Prop ID: 58.C-1-210  
Prop Location: 1 WATERMILL PL UNIT 210 Arlington, MA  
Owner: YANG SHENGYUAN &  
Co-Owner: LONG LIJUAN  
Mailing Address:  
1 WATERMILL PL #210  
ARLINGTON, MA 02476  
-----

Prop ID: 58.C-1-211  
Prop Location: 1 WATERMILL PL UNIT 211 Arlington, MA  
Owner: GREENE SHERRY A  
Co-Owner:  
Mailing Address:  
1 WATERMILL PL #211  
ARLINGTON, MA 02476  
-----

Prop ID: 58.C-1-212  
Prop Location: 1 WATERMILL PL UNIT 212 Arlington, MA  
Owner: WEBBER SUSAN D  
Co-Owner:  
Mailing Address:  
1 WATERMILL PL # 212  
ARLINGTON, MA 02476  
-----

Prop ID: 58.C-1-214  
Prop Location: 1 WATERMILL PL UNIT 214 Arlington, MA  
Owner: LEAL RAFAELA  
Co-Owner:  
Mailing Address:  
1 WATERMILL PL # 214  
ARLINGTON, MA 02476  
-----

-----  
Prop ID: 58.C-1-109  
Prop Location: 1 WATERMILL PL UNIT 109 Arlington, MA  
Owner: SCIUCCO FIORE A  
Co-Owner:  
Mailing Address:  
1 WATERMILL PL #109  
ARLINGTON, MA 02476  
-----

Prop ID: 58.C-1-110  
Prop Location: 1 WATERMILL PL UNIT 110 Arlington, MA  
Owner: BIRD DAVID G  
Co-Owner:  
Mailing Address:  
1 WATERMILL PL # 110  
ARLINGTON, MA 02476  
-----

Prop ID: 58.C-1-111  
Prop Location: 1 WATERMILL PL UNIT 111 Arlington, MA  
Owner: FRENIER SARA A  
Co-Owner:  
Mailing Address:  
1 WATERMILL PL #111  
ARLINGTON, MA 02476  
-----

Prop ID: 58.C-1-112  
Prop Location: 1 WATERMILL PL UNIT 112 Arlington, MA  
Owner: CHELIKANI RAHUL &  
Co-Owner: KOTAGIRI NAMRATA  
Mailing Address:  
1 WATERMILL PL #112  
ARLINGTON, MA 02476  
-----

Prop ID: 58.C-1-114  
Prop Location: 1 WATERMILL PL UNIT 114 Arlington, MA  
Owner: HONTON STEPHEN P  
Co-Owner: PETERSCHMITT MARIA JUDITH  
Mailing Address:  
49 PAYSON TERR  
BELMONT, MA 02478  
-----

Prop ID: 58.C-1-115  
Prop Location: 1 WATERMILL PL UNIT 115 Arlington, MA  
Owner: LECCACORVI KRISTEN  
Co-Owner: LOPEZ RICARDO  
Mailing Address:  
1 WATERMILL PL #115  
ARLINGTON, MA 02474  
-----

Prop ID: 58.C-1-116  
Prop Location: 1 WATERMILL PL UNIT 116 Arlington, MA  
Owner: LYONS MARY T  
Co-Owner:  
Mailing Address:  
1 WATERMILL PL #116  
ARLINGTON, MA 02476  
-----

Prop ID: 58.C-1-117  
Prop Location: 1 WATERMILL PL UNIT 117 Arlington, MA  
Owner: KOUL AJAY  
Co-Owner:  
Mailing Address:  
17 PHEASANT LN  
LEXINGTON, MA 02421  
-----

-----  
Prop ID: 58.C-1-118  
Prop Location: 1 WATERMILL PL UNIT 118 Arlington, MA  
Owner: LOPES MARIETTA  
Co-Owner:  
Mailing Address:  
1 WATERMILL PL #118  
ARLINGTON, MA 02476  
-----

Prop ID: 58.C-1-119  
Prop Location: 1 WATERMILL PL UNIT 119 Arlington, MA  
Owner: DOHERTY JOHN J & ANN/LIFE ESTA  
Co-Owner:  
Mailing Address:  
1 WATERMILL PL #119  
ARLINGTON, MA 02476  
-----

Prop ID: 58.C-1-120  
Prop Location: 1 WATERMILL PL UNIT 120 Arlington, MA  
Owner: RAUCHWARGER JUDITH  
Co-Owner:  
Mailing Address:  
1 WATERMILL PL #120  
ARLINGTON, MA 02476  
-----

Prop ID: 58.C-1-121  
Prop Location: 1 WATERMILL PL UNIT 121 Arlington, MA  
Owner: BROOK REALTY LLC  
Co-Owner:  
Mailing Address:  
1 WATERMILL PL #121  
ARLINGTON, MA 02476  
-----

Prop ID: 58.C-1-122  
Prop Location: 1 WATERMILL PL UNIT 122 Arlington, MA  
Owner: PETROWSKY JOAN  
Co-Owner:  
Mailing Address:  
1 WATERMILL PL #122  
ARLINGTON, MA 02476  
-----

Prop ID: 58.C-1-123  
Prop Location: 1 WATERMILL PL UNIT 123 Arlington, MA  
Owner: GIAUQUE MICHAEL & ANN  
Co-Owner:  
Mailing Address:  
1 WATERMILL PL #123  
ARLINGTON, MA 02476  
-----

Prop ID: 58.C-1-124  
Prop Location: 1 WATERMILL PL UNIT 124 Arlington, MA  
Owner: MUGNAI DONALD J  
Co-Owner:  
Mailing Address:  
1 WATERMILL PL #124  
ARLINGTON, MA 02476  
-----

Prop ID: 58.C-1-125  
Prop Location: 1 WATERMILL PL UNIT 125 Arlington, MA  
Owner: KELLEHER MARIA D  
Co-Owner: ANTHONY REBECCA H  
Mailing Address:  
1 WATERMILL PL #125  
ARLINGTON, MA 02476  
-----



## Abutters List

Date: December 08, 2020

Subject Property Address: 59 LOWELL ST Arlington, MA

Subject Property ID: 58-6-9

Search Distance: 100 Feet

---

### Prop ID: 58-6-9

Prop Location: 59 LOWELL ST Arlington, MA

Owner: MORIARTY KATHLEEN M

Co-Owner:

Mailing Address:

59 LOWELL ST  
ARLINGTON, MA 02476

---

### Prop ID: 58-6-10

Prop Location: 61 LOWELL ST Arlington, MA

Owner: MURRAY RICHARD & KATHERINE

Co-Owner:

Mailing Address:

61 LOWELL ST  
ARLINGTON, MA 02476

---

### Prop ID: 58-6-11.A

Prop Location: 63 LOWELL ST Arlington, MA

Owner: CHANEY BRIDGET M/TRUSTEE

Co-Owner: BRIDGET CHANEY TRUST

Mailing Address:

13780 JULIAS WAY UNIT 1013  
FORT MYERS, FL 33919

---

### Prop ID: 58-6-5.A

Prop Location: 51 LOWELL ST Arlington, MA

Owner: SITTEL CORNELIA

Co-Owner:

Mailing Address:

51 LOWELL ST  
ARLINGTON, MA 02476

---

### Prop ID: 58-6-6

Prop Location: 53 LOWELL ST Arlington, MA

Owner: WHITE ALEKSANDR J & LAURA F

Co-Owner:

Mailing Address:

53 LOWELL ST  
ARLINGTON, MA 02476

---

### Prop ID: 58-6-7

Prop Location: 57 LOWELL ST Arlington, MA

Owner: CALLAHAN DANIEL J IV

Co-Owner: CALLAHAN ELIZABETH

Mailing Address:

57 LOWELL ST  
ARLINGTON, MA 02476

---

### Prop ID: 58.C-1-1

Prop Location: 1 WATERMILL PL UNIT 1 Arlington, MA

Owner: ALEXANDER FREDERICK J/TRUSTEE

Co-Owner: C.A. NOMINEE TRUST

Mailing Address:

1 WATERMILL PL #1  
ARLINGTON, MA 02476

---

### Prop ID: 58.C-1-101

Prop Location: 1 WATERMILL PL UNIT 101 Arlington, MA

Owner: SHEPARDSON KEVIN W & NINA E

Co-Owner:

Mailing Address:

1 WATERMILL PL #101  
ARLINGTON, MA 02476

---

### Prop ID: 58.C-1-102

Prop Location: 1 WATERMILL PL UNIT 102 Arlington, MA

Owner: CUSICK PETER J

Co-Owner:

Mailing Address:

1 WATERMILL PL #102  
ARLINGTON, MA 02476

---

### Prop ID: 58.C-1-104

Prop Location: 1 WATERMILL PL UNIT 104 Arlington, MA

Owner: RANGANATHAN RAJESHWARI

Co-Owner: SRIRAMAN VENKATARAMAN

Mailing Address:

103 BRAND ST  
ARLINGTON, MA 02474

---

### Prop ID: 58.C-1-105

Prop Location: 1 WATERMILL PL UNIT 105 Arlington, MA

Owner: KEZERIAN KAREN A/TRUSTEE

Co-Owner: MADDEN SUSAN M/TRUSTEE

Mailing Address:

1 WATERMILL PL #105  
ARLINGTON, MA 02476

---

### Prop ID: 58.C-1-106

Prop Location: 1 WATERMILL PL UNIT 106 Arlington, MA

Owner: MULLANE-ROBINSON KAREN

Co-Owner: MULLANE THOMAS P

Mailing Address:

77 HERITAGE HILL RD  
WINDHAM, NH 03087

---

### Prop ID: 58.C-1-107

Prop Location: 1 WATERMILL PL UNIT 107 Arlington, MA

Owner: MINSON RYAN T & JULIA

Co-Owner:

Mailing Address:

22 LENNON RD  
ARLINGTON, MA 02474

---

### Prop ID: 58.C-1-108

Prop Location: 1 WATERMILL PL UNIT 108 Arlington, MA

Owner: REIS MANUEL R & TERESA C

Co-Owner:

Mailing Address:

2 VINE BROOK WAY  
UNIT 108  
WOBURN, MA 01801