

1. ELEVATIONS REFER TO NAD 83, BENCHMARK: PK NAIL SET IN UTILITY POLE NEAR THE SOUTH EAST PROPERTY CORNER, ELEVATION = 11.9.
2. THE LOCATIONS AND ELEVATIONS OF ALL EXISTING UTILITIES SHALL BE CONSIDERED APPROXIMATE AND MUST BE VERIFIED BY THE CONTRACTOR PRIOR TO ANY CONSTRUCTION. THE CONTRACTOR SHALL VERIFY THE LOCATIONS OF ANY CROSSINGS OF PROPOSED AND EXISTING UTILITIES.
3. MASSACHUSETTS STATE LAW REQUIRES UTILITY NOTIFICATION AT LEAST THREE BUSINESS DAYS PRIOR TO CONSTRUCTION. THE CONTRACTOR SHALL CALL DIG-SAFE AT 1-888-344-7233 IN ORDER TO COMPLY WITH STATE LAW.
4. THIS PLAN IS THE RESULT OF AN INSTRUMENT SURVEY DONE ON THE GROUND 10/28/17, 7/25/18.
5. ALL WORK SHALL BE SUBJECT TO THE INSPECTION BY AND APPROVAL OF THE TOWN ENGINEER & DPW.
6. IN CASES WHERE LEDGE OR BOULDERS ARE ENCOUNTERED, EVERETT M. BROOKS CO. WILL NOT BE RESPONSIBLE FOR THE AMOUNT OF ROCK ENCOUNTERED.
7. IF ANY PART OF THIS DESIGN IS TO BE ALTERED IN ANY WAY, THE DESIGN ENGINEER, AS WELL AS THE APPROVING AUTHORITIES, SHALL BE NOTIFIED IN WRITING BEFORE CONSTRUCTION.
8. ALL OF THE ROOF RUNOFF FROM THE PROPOSED ROOF SURFACES INDICATED SHALL BE COLLECTED BY GUTTERS AND DIRECTED TO THE PROPOSED LEACHING GALLEYS.
9. ALL TOPSOIL, SUBSOIL OR IMPERVIOUS SOIL MUST BE EXCAVATED AND REMOVED BELOW THE LEACHING GALLEYS AND TO A DISTANCE  $\frac{5}{8}$ " LATEROALLY IN ALL DIRECTIONS BEYOND THE SIDES OF THE GALLEYS. BACKFILL AS REQUIRED WITH CLEAN GRANULAR SAND, FREE FROM ORGANIC MATTER AND DELETERIOUS SUBSTANCES. THE SAND SHALL HAVE A PERCOLATION RATE OF 2 MINUTES PER INCH OR FASTER.
10. THE CONTRACTOR IS RESPONSIBLE FOR NOTIFYING THE DESIGN ENGINEER FOR INSPECTIONS OR AS-BUILT LOCATIONS. EVERETT M. BROOKS CO. WILL NOT PROVIDE AS-BUILT CERTIFICATION TO UNINSPECTED BACKFILLED UTILITIES. A MINIMUM OF 48 HOURS NOTICE IS REQUIRED PRIOR TO INSPECTIONS.
11. ANY PROPOSED WALLS BY OTHERS.
12. SOIL CONDITIONS AND GROUNDWATER ELEVATION SHALL BE EVALUATED AT THE TIME OF CONSTRUCTION. THE PROPOSED DRAINAGE SYSTEM SHALL BE MODIFIED, IF REQUIRED.



1. ENTRANCE WIDTH SHALL BE A TWELVE (12) FOOT MINIMUM, BUT NOT LESS THAN THE FULL WIDTH AT POINTS WHERE INGRESS OR EGRESS OCCURS;
2. THE ENTRANCE SHALL BE MAINTAINED IN A CONDITION WHICH SHALL PREVENT TRACKING OR FLOWING OF SEDIMENT OUT PUBLIC RIGHTS-OF-WAY. THIS MAY REQUIRE PERIODIC TOP DRESSING WITH ADDITIONAL STONE AS COMMONS DEMAND AND REPAIR OR CLEANOUT OF ANY MEASURES USED TO TRAP SEDIMENT. ALL SEDIMENT SPILLED, DROPPED, WASHED OR TRACKED OUT PUBLIC RIGHTS-OF-WAY MUST BE REMOVED IMMEDIATELY. BERM SHALL BE PERMITTED. PERIODIC INSPECTION AND MAINTENANCE SHALL BE PROVIDED AS NEEDED.



N.T.S.

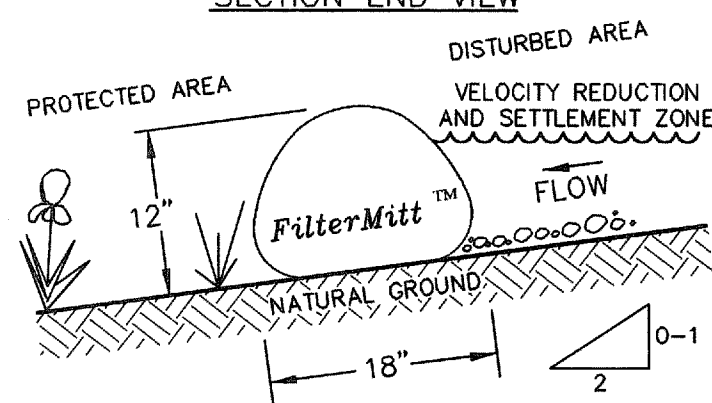

The diagram illustrates the Filler-Mitt™ system. A central vertical oval shape is labeled "Filler-Mitt™". To its left is a "PROTECTED AREA" containing three flower icons. To its right is a "DISTURBED AREA" containing several small circle icons. An arrow labeled "FLOW" points from the disturbed area towards the protected area. A horizontal double-headed arrow below the Filler-Mitt™ indicates a width of "18\"".

OUTSIDE CASING: 100% organic hessian.  
FILLER INGREDIENT: ***FiberRoot Mulch™***  
• A blend of coarse and fine compost and shredded wood.  
• Particle sizes: 100% passing a 3" screen; 90–100% passing a 1" screen; 70–100% passing a 0.75" screen; 30–75% passing a 0.25" screen.  
• Weight: Approx. 850 lbs./cu.yd. (Ave. 30 lbs./l.f.)

For more information visit:  
[www.groundscapecsexpress.com](http://www.groundscapecsexpress.com)  
or contact us at:  
**Groundscapes Express, Inc.**  
P.O. Box 737  
Wrentham, MA 02093  
(508) 384-7140

With the newest technology and equipment, sections can be constructed on site in lengths from 1' to 100'.

Sections can also be delivered to the site in lengths from 1' to 8'.

The flexibility of *FilterMitt*<sup>™</sup> allows it to conform to any contour or terrain while holding a slightly oval shape at 12" high by 18" wide.

Where section ends meet, there shall be an overlap of 6" or greater. Both sides shall be anchored (oak stakes, trees, etc.) to stabilize the union.

2:1 SLOPES OR LESS  
SILTATION CONTROL DETAIL  
N.T.S.

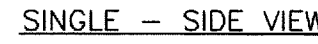

TRAFFIC APPLICATION SIDE  
CULTEC RECHARGER 330XL CHAMBER SYSTEM



SPY POND PARKWAY  
(60' WIDE PUBLIC)

BENCHMARK  
MAGNETIC NAIL  
SET IN UTILITY POLE  
ELEVATION 11.9  
NAD83

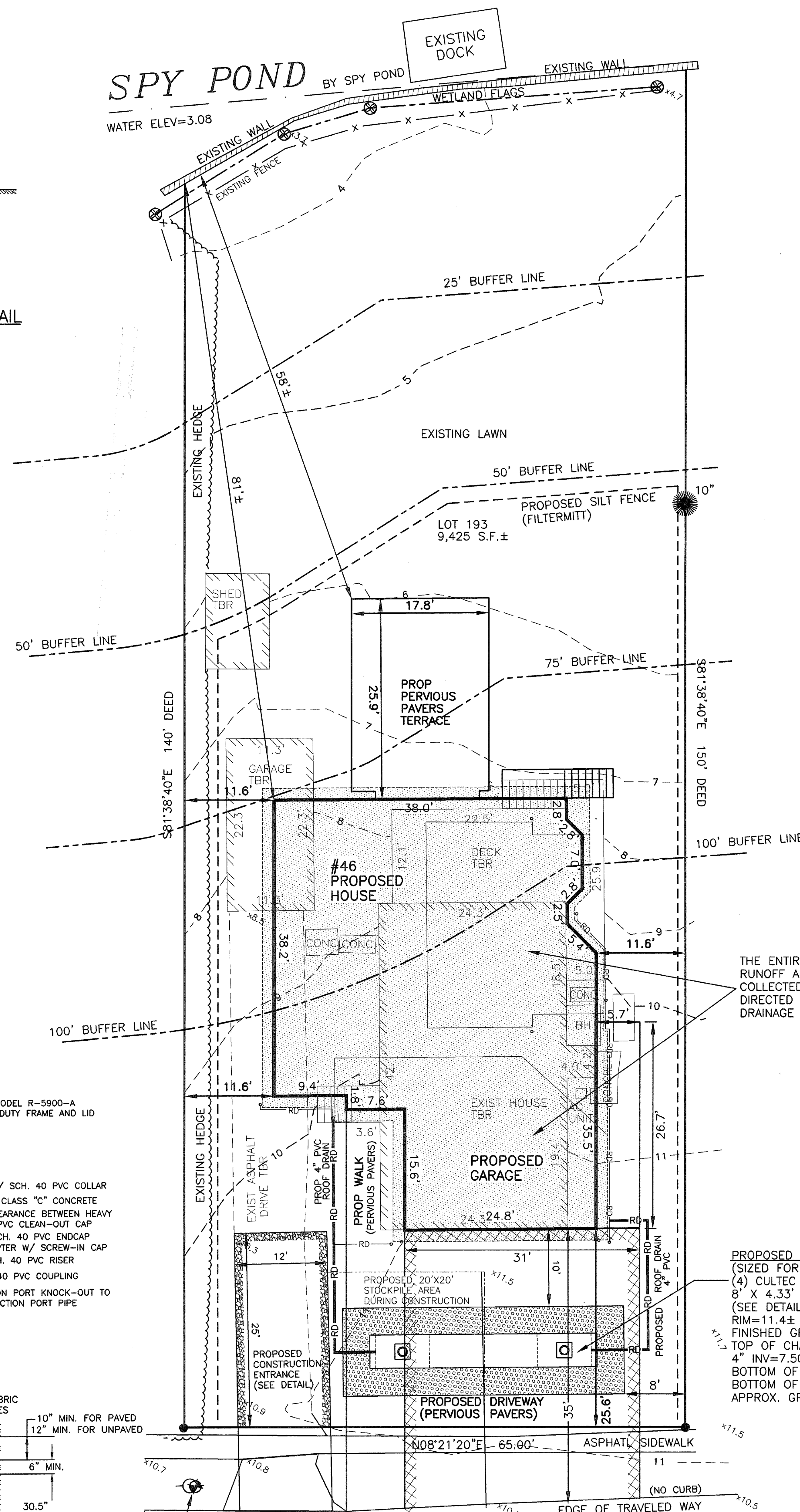

PROPOSED DRAINAGE SYSTEM  
(SIZED FOR THE 100-YR STORM)  
— 4" CULTC RECHARGER 330XL CHAMBERS  
8' X 4.33' W/ 3.5' STONE SURROUND  
(SEE DETAIL)  
RIM=11.4±  
FINISHED GRADE=10.9+  
TOP OF CHAMBERS=8.04  
4" INV=7.50  
BOTTOM OF CHAMBERS=5.50  
BOTTOM OF STONE=5.00  
APPROX. GROUNDWATER ELEVATION=3

46 SPY POND PARKWAY  
PROPOSED ADDITION

SCALE: 1 IN. = 10 FT.  
DATE: SEPTEMBER 4, 2018  
DRAWN: GA/ ES  
CHECK: BB & MSK





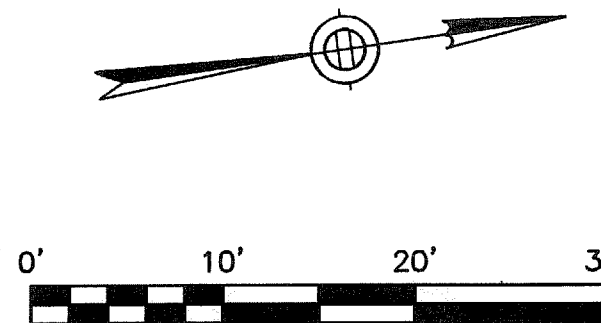







REVISIONS:		
10/23/18	VARIOUS REVISIONS	E

PROJECT NO. 24816



DEED REFERENCE:  
BK 1478 PG 58  
PLAN REFERENCE:  
L.C.C. 16919 D

LEGEND

- |   |                  |
|---|------------------|
|    | UTILITY POLE     |
|    | WATER GATE       |
|    | HYDRANT          |
|    | GAS GATE         |
|    | SEWER MANHOLE    |
|    | DRAIN MANHOLE    |
|    | CATCH BASIN      |
|    | TREE             |
|    | LIGHT POLE       |
|    | SIGN             |
| TBR   | TO BE REMOVED    |
| TBA   | TO BE ABANDONED  |
| THS   | DEEP TEST HOLE   |
| PT1   | PERCOLATION TEST |
| 71.4 X  | SLOPE ELEVATION  |
| [71]  | PROPOSED CONTOUR |
| -71-  | EXISTING CONTOUR |
| -D-   | DRAIN LINE       |
| -FD-  | FOOD DRAIN       |
| -W-   | WATER LINE       |
| -S-   | SEWER LINE       |
| -G-   | GAS LINE         |
| -OHW-   | OVERHEAD WIRES   |
| -X-   | FENCE            |
|  | STONEWALL        |
|  | HEDGE            |
|  | TURF LINE        |

