

EVERSOURCE
101 Linwood Street
Somerville, MA 02143

RECEIVED
SELECTMEN'S OFFICE
ARLINGTON, MA 02476

2019 MAY 28 AM 11:17

May 21, 2019

Town of Arlington
Board of Selectmen/Town Hall
720 Massachusetts Avenue
Arlington, MA 02476

Dear Members of the Board:

The NSTAR Electric Company d/b/a Eversource Energy respectfully requests a Grant of Location for the installation of approximately 12 feet of conduit in Lowell Street, Arlington.

This work is necessary to supply power to 20 Westminster Avenue.

If you have any questions or concerns, please call Jacqueline Duffy at 617-629-3204.

Very truly yours,



Kelly-Ann Correia, Supervisor
Rights and Permits

KC/jc

**PETITION OF NSTAR ELECTRIC COMPANY, d/b/a EVERSOURCE ENERGY
FOR LOCATION FOR CONDUITS AND MANHOLES**

To the **BOARD OF SELECTMEN** of the Town of **Arlington**, Massachusetts:

Respectfully represents **NSTAR ELECTRIC COMPANY, d/b/a Eversource Energy**
a company incorporated for the transmission of electricity for lighting, heating or power, that
it desires to construct a line for such transmission under the public way or ways hereinafter
specified.

WHEREFORE, your petitioner prays that, after due notice and hearing as provided by
law, the Board of Selectmen may by Order grant to your petitioner permission to construct,
and a location for, such a line of conduits and manholes with the necessary wires and cables
therein, said conduits and manholes to be located substantially as shown on the plan made
by **A. DeBenedictis**, dated **May 21, 2019** and filed herewith, under the following
public way or ways of said Town:

**Lowell Street – Northeasterly at pole 845/16, approximately 273 feet west of
Park Avenue, to install approximately 12 feet – conduit.**

W.O. #2319074

**NSTAR ELECTRIC COMPANY
d/b/a Eversource Energy**

By: _____



Kelly-Ann Correia, Supervisor
Rights and Permits

Dated this 21st day of May, 2019

Town of _____ Arlington, _____ Massachusetts

Received and filed _____, 2019

ORDER FOR LOCATION FOR CONDUITS AND MANHOLES

Town of **Arlington,** Massachusetts **May 21, 2019**

WHEREAS, **NSTAR ELECTRIC COMPANY, d/b/a Eversource Energy** has petitioned for permission to construct a line for the transmission of electricity for lighting, heating or power under the public way or ways of the Town hereinafter specified, and notice has been given and a hearing held on said petition as provided by law.

Lowell Street – Northeasterly at pole 845/16, approximately 273 feet west of Park Avenue, to install approximately 12 feet – conduit.

W.O. #2319074

All construction work under this Order shall be in accordance with the following conditions:

1. Conduits and manholes shall be located as shown on a plan made by **A. DeBenedictis** dated **May 21, 2019** on file with said petition.
2. Said Company shall comply with the requirements of existing by-laws and such as may hereafter be adopted governing the construction and maintenance of conduits and manholes.
3. All work shall be done to the satisfaction of the Board of Selectmen or such officer or officers as it may appoint to supervise the work.

1	_____	
2	_____	Board of Selectmen
3	_____	the Town of
4	_____	<u>Arlington</u>
5	_____	

CERTIFICATE

We hereby certify that the foregoing Order was adopted after due notice and a public hearing as prescribed by Section 22 of Chapter 166 of the General Laws (Ter. Ed.), and any additions thereto or amendments thereof, to wit:-after written notice of the time and place of the hearing mailed at least seven days prior to the date of the hearing by the Selectmen to all owners of real estate abutting upon that part of the way or ways upon, along or across which the line is to be constructed under said Order, as determined by the last preceding assessment for taxation, and a public hearing held on the ____ day of _____, 2019 in said Town.

1	_____	
2	_____	Board of Selectmen
3	_____	the Town of
4	_____	<u>Arlington</u>
5	_____	

CERTIFICATE

I hereby certify that the foregoing are true copies of the Order of the Board of Selectmen of the Town of **Arlington,** Massachusetts, duly adopted on the _____ day of _____ 2019 and recorded with the records of location Orders of said Town, Book _____ Page _____ and of the certificate of notice of hearing thereon required by Section 22 of Chapter 166 of the General Laws (Ter. Ed.), and any additions thereto or amendments thereof, as the same appear of record.

Attest: _____

Clerk of the Town of **Arlington,** Massachusetts

W:\SHARED-FILES\TIMES-102\CHANGEBASE\INS\ARL-LOWELL-44.dwg

#131

60-6-7
26 WESTMINSTER AVE
N/F
HOLY SAGE KRP LLC

60-6-11
131 LOWELL ST
N/F
FITZGERALD EDWARD M

APPROX. PT.
OF PICKUP

60-6-8
0 LOWELL ST
N/F
HOLY SAGE
KRP LLC

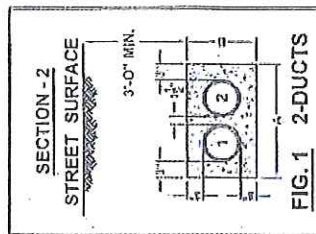
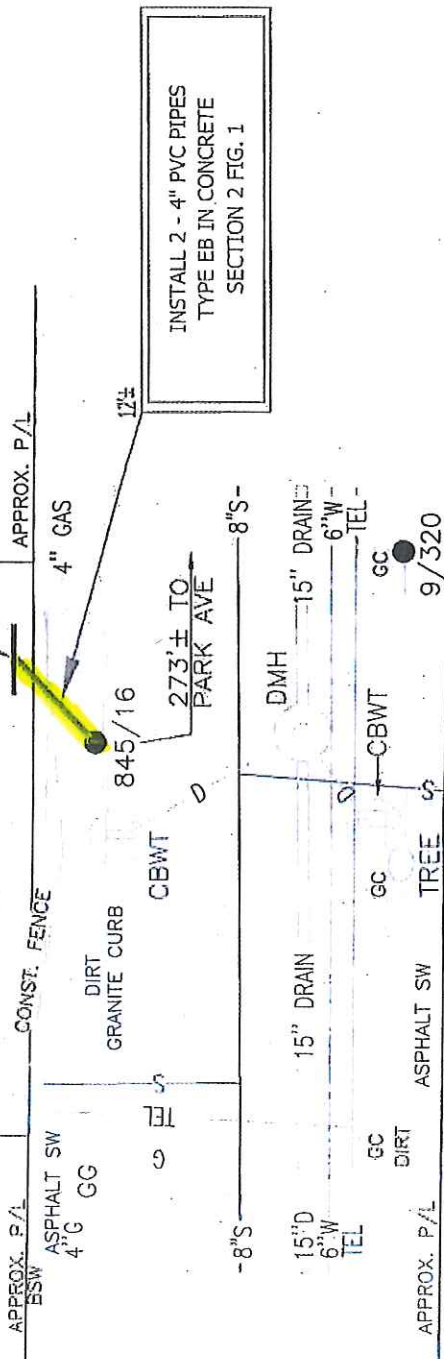

QUANTITIES		ITEMS		QUANTITIES	
NO.	DESCRIPTION	NO.	DESCRIPTION	NO.	DESCRIPTION
1	10' x 10' x 10' CONCRETE	1	10' x 10' x 10' CONCRETE	1	10' x 10' x 10' CONCRETE
2	10' x 10' x 10' CONCRETE	2	10' x 10' x 10' CONCRETE	2	10' x 10' x 10' CONCRETE
3	10' x 10' x 10' CONCRETE	3	10' x 10' x 10' CONCRETE	3	10' x 10' x 10' CONCRETE
4	10' x 10' x 10' CONCRETE	4	10' x 10' x 10' CONCRETE	4	10' x 10' x 10' CONCRETE
5	10' x 10' x 10' CONCRETE	5	10' x 10' x 10' CONCRETE	5	10' x 10' x 10' CONCRETE
6	10' x 10' x 10' CONCRETE	6	10' x 10' x 10' CONCRETE	6	10' x 10' x 10' CONCRETE
7	10' x 10' x 10' CONCRETE	7	10' x 10' x 10' CONCRETE	7	10' x 10' x 10' CONCRETE
8	10' x 10' x 10' CONCRETE	8	10' x 10' x 10' CONCRETE	8	10' x 10' x 10' CONCRETE
9	10' x 10' x 10' CONCRETE	9	10' x 10' x 10' CONCRETE	9	10' x 10' x 10' CONCRETE
10	10' x 10' x 10' CONCRETE	10	10' x 10' x 10' CONCRETE	10	10' x 10' x 10' CONCRETE
11	10' x 10' x 10' CONCRETE	11	10' x 10' x 10' CONCRETE	11	10' x 10' x 10' CONCRETE
12	10' x 10' x 10' CONCRETE	12	10' x 10' x 10' CONCRETE	12	10' x 10' x 10' CONCRETE
13	10' x 10' x 10' CONCRETE	13	10' x 10' x 10' CONCRETE	13	10' x 10' x 10' CONCRETE
14	10' x 10' x 10' CONCRETE	14	10' x 10' x 10' CONCRETE	14	10' x 10' x 10' CONCRETE
15	10' x 10' x 10' CONCRETE	15	10' x 10' x 10' CONCRETE	15	10' x 10' x 10' CONCRETE
16	10' x 10' x 10' CONCRETE	16	10' x 10' x 10' CONCRETE	16	10' x 10' x 10' CONCRETE
17	10' x 10' x 10' CONCRETE	17	10' x 10' x 10' CONCRETE	17	10' x 10' x 10' CONCRETE
18	10' x 10' x 10' CONCRETE	18	10' x 10' x 10' CONCRETE	18	10' x 10' x 10' CONCRETE
19	10' x 10' x 10' CONCRETE	19	10' x 10' x 10' CONCRETE	19	10' x 10' x 10' CONCRETE
20	10' x 10' x 10' CONCRETE	20	10' x 10' x 10' CONCRETE	20	10' x 10' x 10' CONCRETE
21	10' x 10' x 10' CONCRETE	21	10' x 10' x 10' CONCRETE	21	10' x 10' x 10' CONCRETE
22	10' x 10' x 10' CONCRETE	22	10' x 10' x 10' CONCRETE	22	10' x 10' x 10' CONCRETE
23	10' x 10' x 10' CONCRETE	23	10' x 10' x 10' CONCRETE	23	10' x 10' x 10' CONCRETE
24	10' x 10' x 10' CONCRETE	24	10' x 10' x 10' CONCRETE	24	10' x 10' x 10' CONCRETE
25	10' x 10' x 10' CONCRETE	25	10' x 10' x 10' CONCRETE	25	10' x 10' x 10' CONCRETE
26	10' x 10' x 10' CONCRETE	26	10' x 10' x 10' CONCRETE	26	10' x 10' x 10' CONCRETE
27	10' x 10' x 10' CONCRETE	27	10' x 10' x 10' CONCRETE	27	10' x 10' x 10' CONCRETE
28	10' x 10' x 10' CONCRETE	28	10' x 10' x 10' CONCRETE	28	10' x 10' x 10' CONCRETE
29	10' x 10' x 10' CONCRETE	29	10' x 10' x 10' CONCRETE	29	10' x 10' x 10' CONCRETE
30	10' x 10' x 10' CONCRETE	30	10' x 10' x 10' CONCRETE	30	10' x 10' x 10' CONCRETE
31	10' x 10' x 10' CONCRETE	31	10' x 10' x 10' CONCRETE	31	10' x 10' x 10' CONCRETE
32	10' x 10' x 10' CONCRETE	32	10' x 10' x 10' CONCRETE	32	10' x 10' x 10' CONCRETE
33	10' x 10' x 10' CONCRETE	33	10' x 10' x 10' CONCRETE	33	10' x 10' x 10' CONCRETE
34	10' x 10' x 10' CONCRETE	34	10' x 10' x 10' CONCRETE	34	10' x 10' x 10' CONCRETE
35	10' x 10' x 10' CONCRETE	35	10' x 10' x 10' CONCRETE	35	10' x 10' x 10' CONCRETE
36	10' x 10' x 10' CONCRETE	36	10' x 10' x 10' CONCRETE	36	10' x 10' x 10' CONCRETE
37	10' x 10' x 10' CONCRETE	37	10' x 10' x 10' CONCRETE	37	10' x 10' x 10' CONCRETE
38	10' x 10' x 10' CONCRETE	38	10' x 10' x 10' CONCRETE	38	10' x 10' x 10' CONCRETE
39	10' x 10' x 10' CONCRETE	39	10' x 10' x 10' CONCRETE	39	10' x 10' x 10' CONCRETE
40	10' x 10' x 10' CONCRETE	40	10' x 10' x 10' CONCRETE	40	10' x 10' x 10' CONCRETE
41	10' x 10' x 10' CONCRETE	41	10' x 10' x 10' CONCRETE	41	10' x 10' x 10' CONCRETE
42	10' x 10' x 10' CONCRETE	42	10' x 10' x 10' CONCRETE	42	10' x 10' x 10' CONCRETE
43	10' x 10' x 10' CONCRETE	43	10' x 10' x 10' CONCRETE	43	10' x 10' x 10' CONCRETE
44	10' x 10' x 10' CONCRETE	44	10' x 10' x 10' CONCRETE	44	10' x 10' x 10' CONCRETE
45	10' x 10' x 10' CONCRETE	45	10' x 10' x 10' CONCRETE	45	10' x 10' x 10' CONCRETE
46	10' x 10' x 10' CONCRETE	46	10' x 10' x 10' CONCRETE	46	10' x 10' x 10' CONCRETE
47	10' x 10' x 10' CONCRETE	47	10' x 10' x 10' CONCRETE	47	10' x 10' x 10' CONCRETE
48	10' x 10' x 10' CONCRETE	48	10' x 10' x 10' CONCRETE	48	10' x 10' x 10' CONCRETE
49	10' x 10' x 10' CONCRETE	49	10' x 10' x 10' CONCRETE	49	10' x 10' x 10' CONCRETE
50	10' x 10' x 10' CONCRETE	50	10' x 10' x 10' CONCRETE	50	10' x 10' x 10' CONCRETE
51	10' x 10' x 10' CONCRETE	51	10' x 10' x 10' CONCRETE	51	10' x 10' x 10' CONCRETE
52	10' x 10' x 10' CONCRETE	52	10' x 10' x 10' CONCRETE	52	10' x 10' x 10' CONCRETE
53	10' x 10' x 10' CONCRETE	53	10' x 10' x 10' CONCRETE	53	10' x 10' x 10' CONCRETE
54	10' x 10' x 10' CONCRETE	54	10' x 10' x 10' CONCRETE	54	10' x 10' x 10' CONCRETE
55	10' x 10' x 10' CONCRETE	55	10' x 10' x 10' CONCRETE	55	10' x 10' x 10' CONCRETE
56	10' x 10' x 10' CONCRETE	56	10' x 10' x 10' CONCRETE	56	10' x 10' x 10' CONCRETE
57	10' x 10' x 10' CONCRETE	57	10' x 10' x 10' CONCRETE	57	10' x 10' x 10' CONCRETE
58	10' x 10' x 10' CONCRETE	58	10' x 10' x 10' CONCRETE	58	10' x 10' x 10' CONCRETE
59	10' x 10' x 10' CONCRETE	59	10' x 10' x 10' CONCRETE	59	10' x 10' x 10' CONCRETE
60	10' x 10' x 10' CONCRETE	60	10' x 10' x 10' CONCRETE	60	10' x 10' x 10' CONCRETE
61	10' x 10' x 10' CONCRETE	61	10' x 10' x 10' CONCRETE	61	10' x 10' x 10' CONCRETE
62	10' x 10' x 10' CONCRETE	62	10' x 10' x 10' CONCRETE	62	10' x 10' x 10' CONCRETE
63	10' x 10' x 10' CONCRETE	63	10' x 10' x 10' CONCRETE	63	10' x 10' x 10' CONCRETE
64	10' x 10' x 10' CONCRETE	64	10' x 10' x 10' CONCRETE	64	10' x 10' x 10' CONCRETE
65	10' x 10' x 10' CONCRETE	65	10' x 10' x 10' CONCRETE	65	10' x 10' x 10' CONCRETE
66	10' x 10' x 10' CONCRETE	66	10' x 10' x 10' CONCRETE	66	10' x 10' x 10' CONCRETE
67	10' x 10' x 10' CONCRETE	67	10' x 10' x 10' CONCRETE	67	10' x 10' x 10' CONCRETE
68	10' x 10' x 10' CONCRETE	68	10' x 10' x 10' CONCRETE	68	10' x 10' x 10' CONCRETE
69	10' x 10' x 10' CONCRETE	69	10' x 10' x 10' CONCRETE	69	10' x 10' x 10' CONCRETE
70	10' x 10' x 10' CONCRETE	70	10' x 10' x 10' CONCRETE	70	10' x 10' x 10' CONCRETE
71	10' x 10' x 10' CONCRETE	71	10' x 10' x 10' CONCRETE	71	10' x 10' x 10' CONCRETE
72	10' x 10' x 10' CONCRETE	72	10' x 10' x 10' CONCRETE	72	10' x 10' x 10' CONCRETE
73	10' x 10' x 10' CONCRETE	73	10' x 10' x 10' CONCRETE	73	10' x 10' x 10' CONCRETE
74	10' x 10' x 10' CONCRETE	74	10' x 10' x 10' CONCRETE	74	10' x 10' x 10' CONCRETE
75	10' x 10' x 10' CONCRETE	75	10' x 10' x 10' CONCRETE	75	10' x 10' x 10' CONCRETE
76	10' x 10' x 10' CONCRETE	76	10' x 10' x 10' CONCRETE	76	10' x 10' x 10' CONCRETE
77	10' x 10' x 10' CONCRETE	77	10' x 10' x 10' CONCRETE	77	10' x 10' x 10' CONCRETE
78	10' x 10' x 10' CONCRETE	78	10' x 10' x 10' CONCRETE	78	10' x 10' x 10' CONCRETE
79	10' x 10' x 10' CONCRETE	79	10' x 10' x 10' CONCRETE	79	10' x 10' x 10' CONCRETE
80	10' x 10' x 10' CONCRETE	80	10' x 10' x 10' CONCRETE	80	10' x 10' x 10' CONCRETE
81	10' x 10' x 10' CONCRETE	81	10' x 10' x 10' CONCRETE	81	10' x 10' x 10' CONCRETE
82	10' x 10' x 10' CONCRETE	82	10' x 10' x 10' CONCRETE	82	10' x 10' x 10' CONCRETE
83	10' x 10' x 10' CONCRETE	83	10' x 10' x 10' CONCRETE	83	10' x 10' x 10' CONCRETE
84	10' x 10' x 10' CONCRETE	84	10' x 10' x 10' CONCRETE	84	10' x 10' x 10' CONCRETE
85	10' x 10' x 10' CONCRETE	85	10' x 10' x 10' CONCRETE	85	10' x 10' x 10' CONCRETE
86	10' x 10' x 10' CONCRETE	86	10' x 10' x 10' CONCRETE	86	10' x 10' x 10' CONCRETE
87	10' x 10' x 10' CONCRETE	87	10' x 10' x 10' CONCRETE	87	10' x 10' x 10' CONCRETE
88	10' x 10' x 10' CONCRETE	88	10' x 10' x 10' CONCRETE	88	10' x 10' x 10' CONCRETE
89	10' x 10' x 10' CONCRETE	89	10' x 10' x 10' CONCRETE	89	10' x 10' x 10' CONCRETE
90	10' x 10' x 10' CONCRETE	90	10' x 10' x 10' CONCRETE	90	10' x 10' x 10' CONCRETE
91	10' x 10' x 10' CONCRETE	91	10' x 10' x 10' CONCRETE	91	10' x 10' x 10' CONCRETE
92	10' x 10' x 10' CONCRETE	92	10' x 10' x 10' CONCRETE	92	10' x 10' x 10' CONCRETE
93	10' x 10' x 10' CONCRETE	93	10' x 10' x 10' CONCRETE	93	10' x 10' x 10' CONCRETE
94	10' x 10' x 10' CONCRETE	94	10' x 10' x 10' CONCRETE	94	10' x 10' x 10' CONCRETE
95	10' x 10' x 10' CONCRETE	95	10' x 10' x 10' CONCRETE	95	10' x 10' x 10' CONCRETE
96	10' x 10' x 10' CONCRETE	96	10' x 10' x 10' CONCRETE	96	10' x 10' x 10' CONCRETE
97	10' x 10' x 10' CONCRETE	97	10' x 10' x 10' CONCRETE	97	10' x 10' x 10' CONCRETE
98	10' x 10' x 10' CONCRETE	98	10' x 10' x 10' CONCRETE	98	10' x 10' x 10' CONCRETE
99	10' x 10' x 10' CONCRETE	99	10' x 10' x 10' CONCRETE	99	10' x 10' x 10' CONCRETE
100	10' x 10' x 10' CONCRETE	100	10' x 10' x 10' CONCRETE	100	10' x 10' x 10' CONCRETE

LOWELL ST

60-5-6
128 LOWELL ST
N/F
SMITH NANCY T

60-5-7
124-126 LOWELL ST
N/F
BOURIKAS VASSILIOS-ETAL

#122

NOTES:
1. THE LOCATION OF UNDERGROUND UTILITIES ARE FROM PLANS AND RECORDS AND ARE APPROXIMATE ONLY. IN ADDITION, SURFACE FEATURES OF UTILITIES AND SERVICES LOCATED BY FIELD SURVEY ARE TIED TO THEIR NEAREST ADJACENT PROPERTY CORNER OR TO THE NEAREST CONFIRMED UNDERGROUND EXISTENCE AVAILABLE TO THE FIELD SURVEY.
2. ANY UNDERGROUND UTILITIES NOT SHOWN HEREIN ARE REQUESTED BY THE FIELD SURVEY TO BE LOCATED AND REQUESTED BY THE FIELD SURVEY TO BE LOCATED AND REQUESTED BY THE FIELD SURVEY TO BE LOCATED.

BY YOUR USE OF THE INFORMATION CONTAINED IN THIS MAP, YOU AGREE THAT NO WARRANTY OF ANY KIND, EXPRESS OR IMPLIED, IS MADE WITH RESPECT TO THE INFORMATION. THE INFORMATION IS PROVIDED FOR YOUR INFORMATION ONLY. THE INFORMATION IS NOT TO BE USED FOR ANY OTHER PURPOSE. THE INFORMATION IS NOT TO BE USED FOR ANY OTHER PURPOSE. THE INFORMATION IS NOT TO BE USED FOR ANY OTHER PURPOSE.

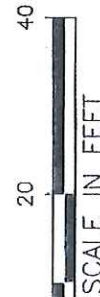

MASS. LAW
REQUIRES 72 HOURS ADVANCE NOTICE TO UTILITY COMPANIES BEFORE DIGGING BY ANYONE. CALL DIG-SAFE 1-888-344-7233

NSIAR EVERSOURCE
1165 MASSACHUSETTS AVE. DORCHESTER, MASS. 02125
Plan of LOWELL ST. (DOWNING SQ)

Showing PROPOSED CONDUIT LOCATION
Arlington
Scale 1"=20'
Date MAY 21, 2019
SHEET 1 of 1

OFFICE OF THE SELECT BOARD

DIANE M. MAHON, CHAIR
DANIEL J. DUNN, VICE CHAIR
JOSEPH A. CURRO, JR.
JOHN V. HURD
STEPHEN W. DECOURCEY



730 MASSACHUSETTS AVENUE
TELEPHONE
781-316-3020
781-316-3029 FAX

TOWN OF ARLINGTON
MASSACHUSETTS 02476-4908

May 29, 2019

Kelly Ann Correia, Supervisor
Rights and Permits
Eversource
101 Linwood Street
Somerville, MA 02143

Re: Lowell Street, W.O. #2319074

Dear Ms. Correia:

A Public Hearing has been scheduled in conjunction with the above-captioned matter on Monday, June 17th, 7:15 p.m., Select Board Chambers, Town Hall, 730 Massachusetts Avenue, Arlington.

The abutters have been notified. Please call our office to confirm the date and time with either Fran, Ashley or Lauren.

Thank you.

Very truly yours,
SELECT BOARD

Marie A. Krepelka

Marie A. Krepelka
Board Administrator

MAK:fr

NOTICE TO ABUTTERS

May 29, 2019

Dear Abutter:

You are hereby notified that a public hearing will be held at the **Office of the Select Board, Town Hall, 730 Massachusetts Avenue, Arlington, Massachusetts**, on the **17th of June at 7:15 p.m.** upon the Petition of **NStar Electric d/b/a Eversource Energy** for permission to construct, and a location for, such a line of conduits and manholes, with the necessary wires and cables therein, said conduits and manholes to be located substantially as shown on the plan made by A. DeBenedictis, dated May 21, 2019 and filed herewith, under the following public way or ways of said Town:

W.O. #2319074

Lowell Street: **Northeasterly at pole 845/16, approximately 273 feet west of Park Avenue, to install approximately 12 feet - conduit.**

By: Marie A. Krupelba
Board Administrator

FITZGERALD EDWARD M
10 CALVIN STREET
LEXINGTON, MA 02420

SMITH NANCY T &
GUSTIN CHRISTOPHER S
128 LOWELL STREET
ARLINGTON, MA 02474

LUBERTAZZI MARIA A
133 LOWELL ST
ARLINGTON, MA 02474

OWENS JOHN
OWENS BARBARA
116-118 LOWELL ST UNIT 118
ARLINGTON, MA 02474

HOUSING CORPORATION OF
ARLINGTON
252 MASS AVE
ARLINGTON, MA 02474

BOURIKAS VASSILIOS--ETAL
BOURIKAS MARIA
126 LOWELL STREET
ARLINGTON, MA 02474

HOLY SAGE KRP LLC
252 MASS AVE
ARLINGTON, MA 02474

LANTHIER ELEANOR A
132 LOWELL ST
ARLINGTON, MA 02474

NEELY JOHN J & DEBORAH
120-122 LOWELL ST
ARLINGTON, MA 02474

SINGELAIS STEVEN M
116 LOWELL ST
ARLINGTON, MA 02474