

April 29, 2020

Emily Sullivan
Environmental Planner & Conservation Agent
Town of Arlington Conservation Commission
730 Massachusetts Avenue, Annex
Arlington, Massachusetts 02476

**RE: Response to Conservation Commission Comments
D'Agostino's Delicatessen
1297 Massachusetts Avenue, Arlington, MA**

Dear Ms. Sullivan,

Wilcox & Barton, Inc. is pleased to submit this letter addressing the comments provided in the Conservation Commission public hearing held on April 16, 2020. Enclosed please find electronic copies of the revised site plans, weekly inspection record form for the subject property, and an applicable portion of a Massachusetts Office of Coastal Zone Management (CZM) list of native shrubs and groundcovers. The project plans have been revised as follows:

Commission Comments dated April 16, 2020

1. A weekly inspection record form for the subject property has been provided. See attached.
2. In addition to the erosion control matting and grass mix, Sweet Ferns (*Comptonia Peregrina*) are proposed to be planted throughout the proposed excavation area as specified on sheets C1.1 and C5.1. See the attached CZM list for details on Sweet Ferns.
3. Proposed perimeter erosion and sediment controls during construction shall be 12-inch compost socks. See sheets C1.1 and C5.1.

If you have any questions, or require additional information, please contact me at (603) 369-4190 x502.

Very truly yours,

WILCOX & BARTON, INC.

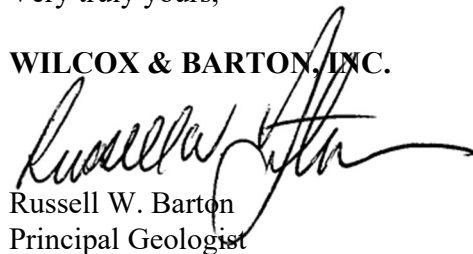

Russell W. Barton
Principal Geologist

Attachments: Revised Site Plan Sheets
- C1.1 Site Plan
- C5.1 Construction & Erosion Control Details
Weekly Inspection Record Form
CZM Native Shrubs and Groundcovers List

Coastal Landscaping in Massachusetts

Plant Highlights and Images: Shrubs and Groundcovers

This PDF document provides graphics and additional information to supplement the Massachusetts Office of Coastal Zone Management (CZM) [Coastal Landscaping Website](#).

The following list provides descriptions and photographs of some of the most common and useful shrubs and groundcovers appropriate for coastal landscaping projects in Massachusetts. Unless otherwise noted, the listed plants are *native* to Massachusetts. For more coastal plants, see [Plant Highlights and Images](#) for PDF fact sheets on Grasses/Perennials and Trees.

Shrubs and Groundcovers

Arrowwood *Viburnum dentatum*



Photo: University of Connecticut Plant Database

Arrowwood viburnum is a dense, multi-stemmed shrub that typically grows 5 to 9 feet tall and wide. The branches are upright and spreading and arch at the tips. The leaves are either a shiny or flat dark green and turn yellow or red to red-purple in the late fall. The showy flowers are small, white, flattened clusters, which bloom late May to early June. The fruit, which can be of an intense blue color, is ornamental and a food source for birds. Arrowwood is very easy to grow, being well adapted to full sun or partial shade and to dry or fairly wet soils. Arrowwood is useful for its hardiness, as a border or screen, for naturalized plantings, to attract birds, and for difficult sites. This shrub is free from serious problems, with the only main maintenance requirement being an occasional rejuvenation pruning.

Beach Heather (*Hudsonia tomentosa*)



Photo: Richard A. Howard Image Collection, courtesy of Smithsonian Institution

Beach heather is a low-growing perennial shrub that thrives in nutritionally poor sand, therefore making it a dominant species in the dune ecosystem. Beach heather is beneficial for other plants because it enriches the soil with nitrogen. Beach heather has scaly leaves covered with fine, hair-like structures that protect the plant from moisture loss due to the wind and the sun's heat. Off the tips of the branches grow clusters of bright yellow flowers. Beach heather functions to stabilize dunes with its carpet-like surface area that catches and holds the sand in place and its network of roots that binds the sediments.

Shrubs and Groundcovers

Red Chokeberry (*Aronia arbutifolia*)



Photo: University of Connecticut Plant Database

Red chokeberry is native throughout most of the eastern United States and is found in various habitats from dry hillsides to wetland areas. This deciduous shrub grows from 6 to 10 feet tall and 3 to 5 feet wide. It is a suckering, spreading, colonizing shrub with numerous, slender stems. Red chokeberry is tolerant of partial shade and of both dry and wet sites. It can be transplanted easily and is valued for its summer flowers, persistent fruit, and colorful fall foliage. It is useful for naturalistic plantings, bank and dune stabilization, colonization and mass plantings, or borders in a garden.

Shrubby Cinquefoil (*Potentilla fruticosa*)



Photo: CZM

Also known as bush cinquefoil, this deciduous shrub typically grows 2 to 4 feet high and has a mound-shaped form and compound pinnate leaves. The five-petaled, bright-yellow flowers have a long blooming period, often appearing in the spring and continuing through early fall. Though shrubby cinquefoil does best in fertile, medium-moisture, well-drained soils in full sun, established plants grow well in a wide range of conditions, are fairly resistant to drought and saline soils, and are tolerant of some shade. Shrubby cinquefoil is also very tolerant of cold. The dense growth of this shrub provides cover for wildlife, the seed capsules provide fall and winter food for birds, and the flowers provide an excellent source of nectar for bees and butterflies. The variety 'Pink Beauty' is shown in the photograph.

Sweet Fern (*Comptonia peregrina*)



Photo: CZM

Sweet fern is a low-growing, deciduous native shrub that is 2 to 4 feet in height, with sweet-scented, fern-like leaves that are particularly aromatic when crushed. Sweet fern is a loosely branched, spreading, and colonizing plant. The flowers are small, inconspicuous catkins that bloom from April to May. Sweet fern is extremely cold hardy and prefers acidic, sandy, or peaty soils with low fertility, but does not tolerate shading. Sweet fern produces many underground stems or rhizomes, making it an effective groundcover for erosion control on steep, sandy banks and for species diversity in sterile, sandy soils.

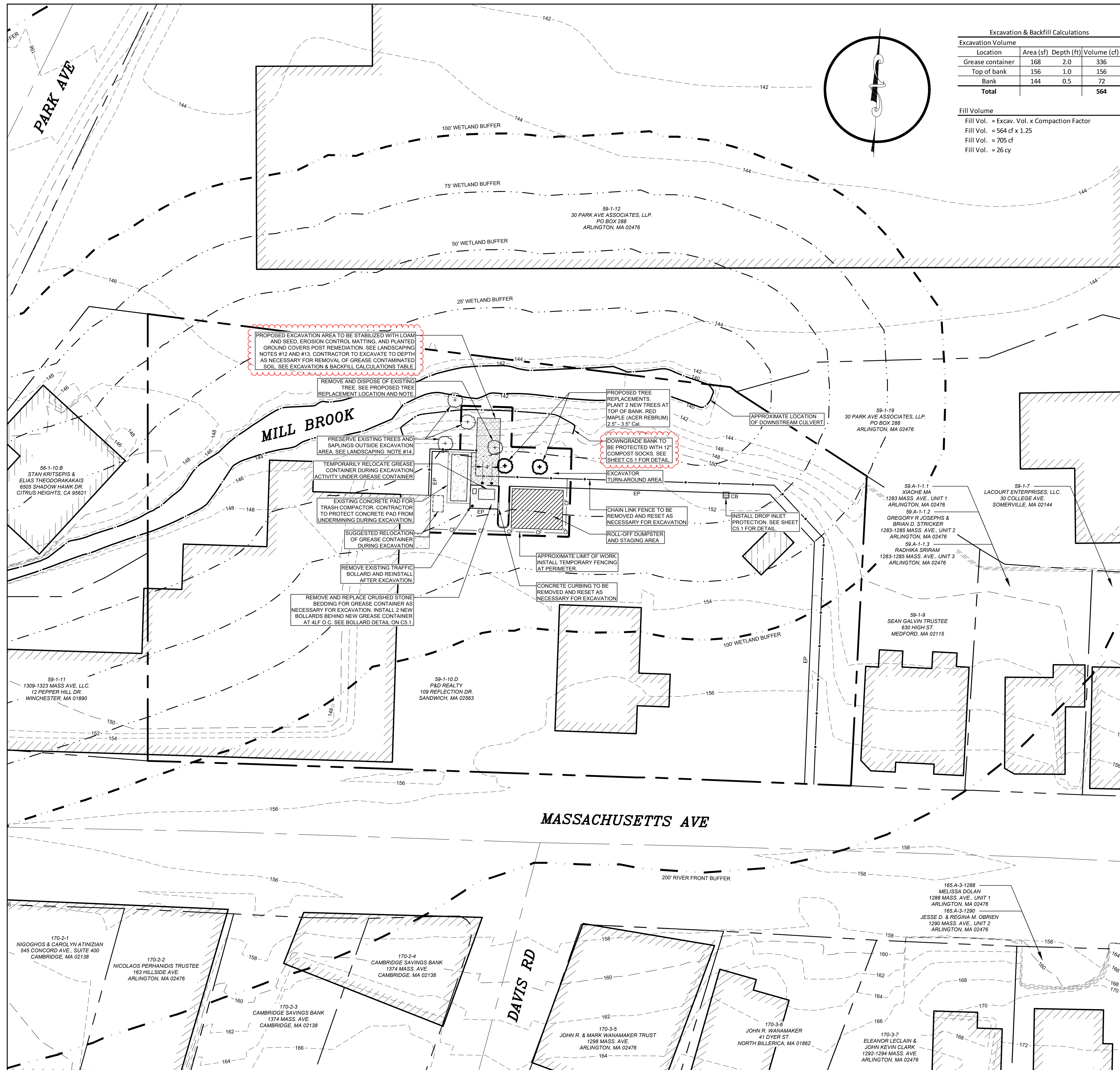

Excavation & Backfill Calculations

Location	Area (sf)	Depth (ft)	Volume (cf)
Grease container	168	2.0	336
Top of bank	156	1.0	156
Bank	144	0.5	72
Total			564

Fill Volume
 Fill Vol. = Excav. Vol. x Compaction Factor
 Fill Vol. = 564 cf x 1.25
 Fill Vol. = 705 cf
 Fill Vol. = 26 cy

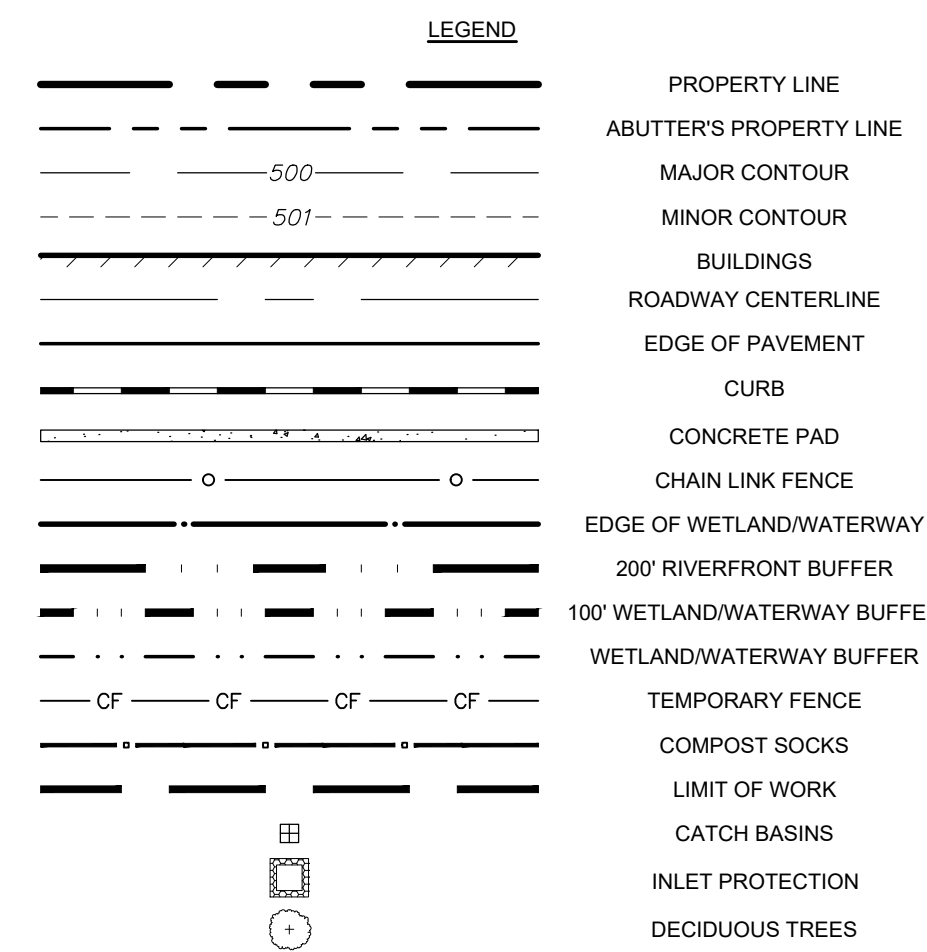

GENERAL NOTES:

- EXISTING CONDITIONS, NORTH ORIENTATION, AND COORDINATE VALUES DEPICTED ON THESE DRAWINGS ARE BASED ON DATA COLLECTED AND PROVIDED BY THE BUREAU OF GEOGRAPHIC INFORMATION (MASSGIS), COMMONWEALTH OF MASSACHUSETTS, EXECUTIVE OFFICE OF TECHNOLOGY AND SECURITY SERVICES. 1.1. STRUCTURES LAYER UPDATED AUGUST 2019 1.2. TAX PARCELS LAYER UPDATED JANUARY 2020 1.3. ROAD CENTER LINES LAYER UPDATED NOVEMBER 2018
- TOPOGRAPHICAL INFORMATION PROVIDED BY THE TOWN OF ARLINGTON, MA GIS DATA "2-FOOT ELEVATION CONTOURS" DATED 2018.
- CONTRACTOR IS RESPONSIBLE FOR ADEQUATE BRACING OF WALLS AND/OR SHORING OF EXCAVATIONS DURING CONSTRUCTION.

- THE CONTRACTOR SHALL REVIEW AND STAMP ALL SHOP DRAWINGS AND SUBMITTALS BEFORE SUBMISSION TO THE ENGINEER. THIS, PROVIDING ANY INFORMATION REQUIRED OF THE FABRICATOR SUCH AS FIELD DIMENSIONS, ELEVATIONS, ETC. OTHERWISE THE SHOP DRAWINGS OR SUBMITTALS WILL BE REJECTED UNTIL SUCH INFORMATION IS FURNISHED BY THE CONTRACTOR.
- BACKFILL SHALL BE COMPACTED TO 95% OF THE MAXIMUM DENSITY AT OPTIMUM MOISTURE CONTENT. ASTM D1557.
- THE CONTRACTOR SHALL CONTACT DIG-SAFE (1-888-DIG-SAFE) AT LEAST 48 HOURS AND LESS THAN 30 DAYS PRIOR TO STARTING CONSTRUCTION AND SHALL VERIFY ALL UTILITY LOCATIONS IN THE FIELD.
- CONTRACTOR WILL NOTIFY ENGINEERS IMMEDIATELY IF SITE CONDITIONS DIFFER FROM WHAT IS SHOWN ON PLAN.

LANDSCAPING NOTES:

- CONTRACTOR SHALL BE RESPONSIBLE FOR ANY COORDINATION WITH SUBCONTRACTORS AS REQUIRED TO ACCOMPLISH PLANTING OPERATIONS
- LANDSCAPE CONTRACTOR SHALL RECEIVE SITE GRADE TO +/- 0.10 FOOT.
- ALL PLANT MATERIALS AND FINAL LOCATION OF ALL PLANT MATERIALS SHALL BE SUBJECT TO THE APPROVAL OF THE OWNER'S REPRESENTATIVE PRIOR TO INSTALLATION
- IF CONFLICTS ARISE BETWEEN SIZE OF AREAS AND PLANS, CONTRACTOR SHALL CONTACT OWNER'S REPRESENTATIVE FOR IMMEDIATE RESOLUTION. FAILURE TO MAKE SUCH CONFLICTS KNOWN TO THE OWNER'S REPRESENTATIVE WILL RESULT IN CONTRACTOR'S LIABILITY TO RELOCATE THE MATERIALS.
- CONTRACTOR SHALL FURNISH PLANT MATERIALS FREE OF PESTS OR PLANT DISEASES. PRE-SELECTED OR "TAGGED" MATERIAL MUST BE INSPECTED BY THE CONTRACTOR AND CERTIFIED AS PEST AND DISEASE FREE. IT IS THE CONTRACTOR'S OBLIGATION TO WARRANTY ALL PLANT MATERIALS.
- ALL GROUND COVERS SHALL BE TRIANGULARLY SPACED UNLESS OTHERWISE NOTED.
- CONTRACTOR SHALL BE RESPONSIBLE FOR REPLACEMENT OF ANY EXISTING MATERIALS DAMAGED DURING PLANTING OPERATIONS.
- ALL LANDSCAPE AREAS SHALL BE COVERED WITH 2-INCHES OF ORGANIC BARK MULCH UNLESS OTHERWISE NOTED.
- AREAS SHOWN AS GROUND COVER AT THE BASE OF TREE AND SHRUB MATERIALS MUST CONFORM TO THE FOLLOWING CRITERIA. THERE SHALL BE NO GROUND COVER PLANT MATERIAL AT THE BASE OF THE TREE OR SHRUB AS FOLLOWS: A) 4-FOOT RADIUS AROUND EVERGREEN TREES, B) 3-FOOT RADIUS AROUND DECIDUOUS TREES; AND C) 2-FOOT RADIUS AROUND LARGE SHRUBS.
- FINAL PLACEMENT OF ALL PLANT MATERIALS SHALL BE SUBJECT TO APPROVAL OF OWNER'S REPRESENTATIVE PRIOR TO FINAL PLACEMENT AND BACKFILL. CONTACT OWNER'S REPRESENTATIVE 24-HOURS PRIOR TO PLACEMENT FOR APPROVAL.
- ALL DISTURBED AREAS, UNLESS OTHERWISE NOTED, TO BE LOAM, SEEDED, AND MULCHED
- CONTRACTOR TO USE NORTH AMERICAN GREEN BIONET SC1508N MATTING FOR ALL EROSION CONTROL MATTING. 70% STRAW / 30% COCONUT FIBER MATRIX.
- CONTRACTOR TO USE SWEET FERNS (COMPTONIA PEREGRINA) FOR ALL GROUND COVER PLANTINGS. SWEET FERNS SHALL BE PLANTED WITHIN THE EXCAVATION AREA NORTH OF THE EXISTING CHAIN LINK FENCE AND SPACED AT 2 FT TO 3 FT. SEE SHEET CS.1 FOR INSTALLATION DETAILS.
- CONTRACTOR SHALL PRESERVE AND PROTECT EXISTING TREE ROOTS. IF ADDITIONAL TREES NEED TO BE IMPACTED FOR REMEDIATION ACTIVITIES CONTACT ENGINEER IMMEDIATELY.

EROSION CONTROL SEED

SEED	BY % MASS	% GERMINATION (MIN)
WINTER RYE 80 (MIN)	80 (MIN)	85
RED FESCUE (CREEPING) 4 (MIN)	4 (MIN)	80
PERENNIAL GRASS 3 (MIN)	3 (MIN)	90
RED CLOVER 3 (MIN)	3 (MIN)	90
OTHER CROP GRASS	0.5 (MAX)	
NOXIOUS WEED SEED	0.5 (MAX)	
INERT MATTER	1.0 (MAX)	

PERMANENT SEED MIX

SEED	BY % MASS	% GERMINATION (MIN)
RED FESCUE (CREEPING) 50	50	85
KENTUCKY BLUE 25	25	85
PERENNIAL RYE GRASS 10	10	90
RED TOP 10	10	85
LANDINO CLOVER 5	5	85

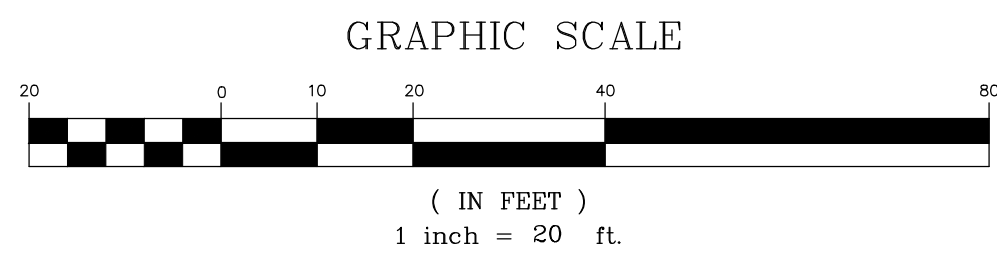

Wilcox & Barton INC.
 CIVIL • ENVIRONMENTAL • GEOTECHNICAL

2 CAPITAL PLAZA, SUITE 305
 CONCORD, NH 03301
 603-369-4190
 www.wilcoxandbarton.com

REVISION HISTORY
 1. RESPONSE TO CONSERVATION COMMISSION COMMENTS (04/24/2020)

Permitting

ALL DOCUMENTS PREPARED BY WILCOX & BARTON, INC. ARE INSTRUMENTS OF SERVICE IN RESPECT OF THE PROJECT. THEY ARE NOT INTENDED OR REPRESENTED TO BE SUITABLE FOR REUSE BY OWNER OR OTHERS. ANY REUSE WITHOUT WRITTEN VERIFICATION OR ADAPTATION BY WILCOX & BARTON, INC. FOR THE SPECIFIC PURPOSE INTENDED WILL BE AT OWNER'S SOLE RISK AND WITHOUT LIABILITY OR LEGAL EXPOSURE TO WILCOX & BARTON, INC. OWNER SHALL INDEMNIFY AND HOLD HARMLESS WILCOX & BARTON, INC. FROM ALL CLAIMS, DAMAGES, LOSSES AND EXPENSES ARISING OUT OF OR RESULTING THEREFROM.

P&D REALTY
 109 REFLECTION DR
 SANDWICH, MA

D'AGOSTINO'S DELICATESSEN
 1297 MASS. AVE.
 ARLINGTON, MA

Map/Block/Lot: 59/1/10D

Site Plan

Scale	1" = 20'	Date	03/04/2020
Drafted By	RSR	Checked By	DLF
Project Mgr	RWB	Project Number	PDRE0001

ENGINEER: DAVID L. FROTHINGHAM III
 MA P.E. #53992

C1.1

1 of 2

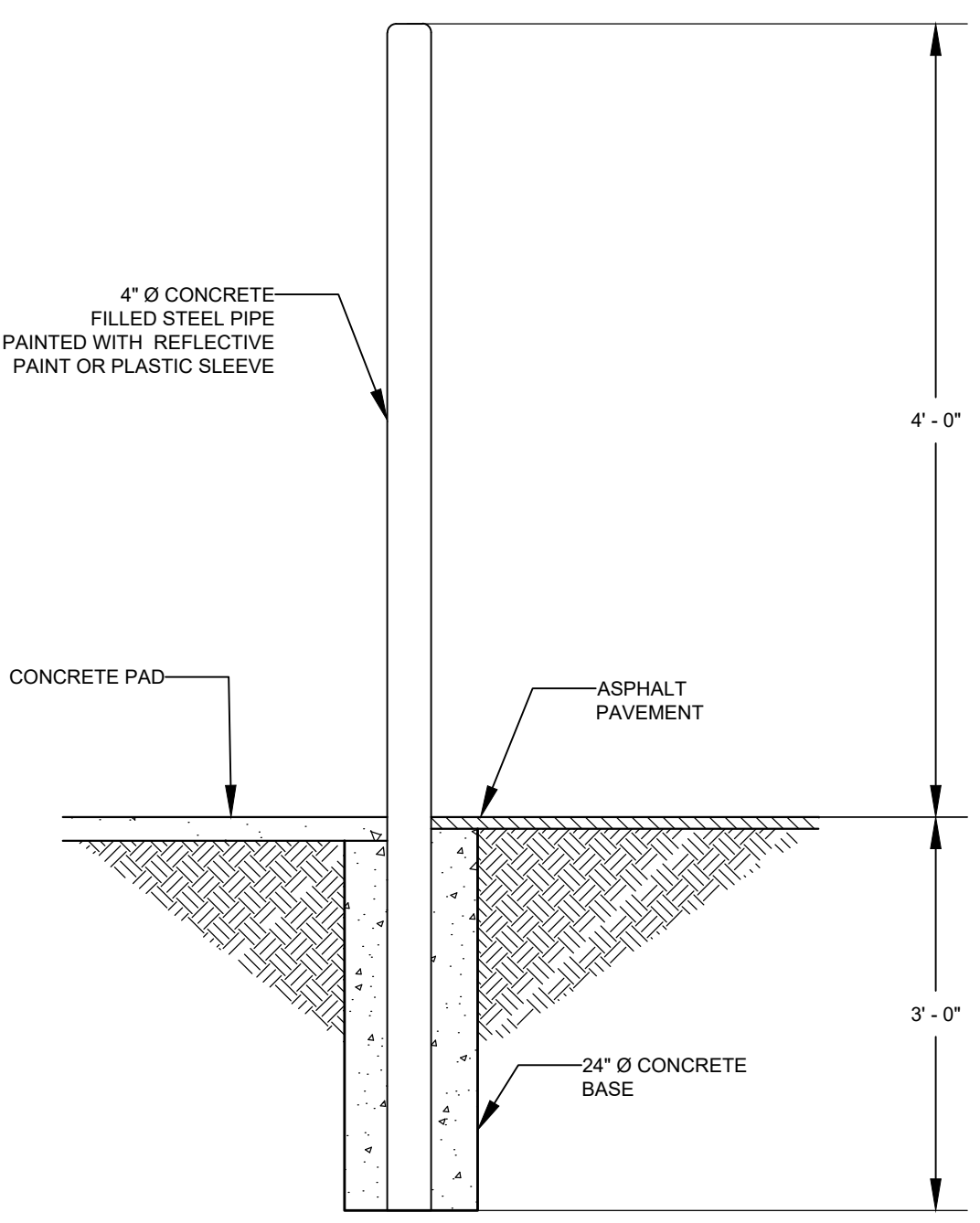

TRAFFIC BOLLARD
SOURCE: WILCOX & BARTON, INC.
NOT TO SCALE

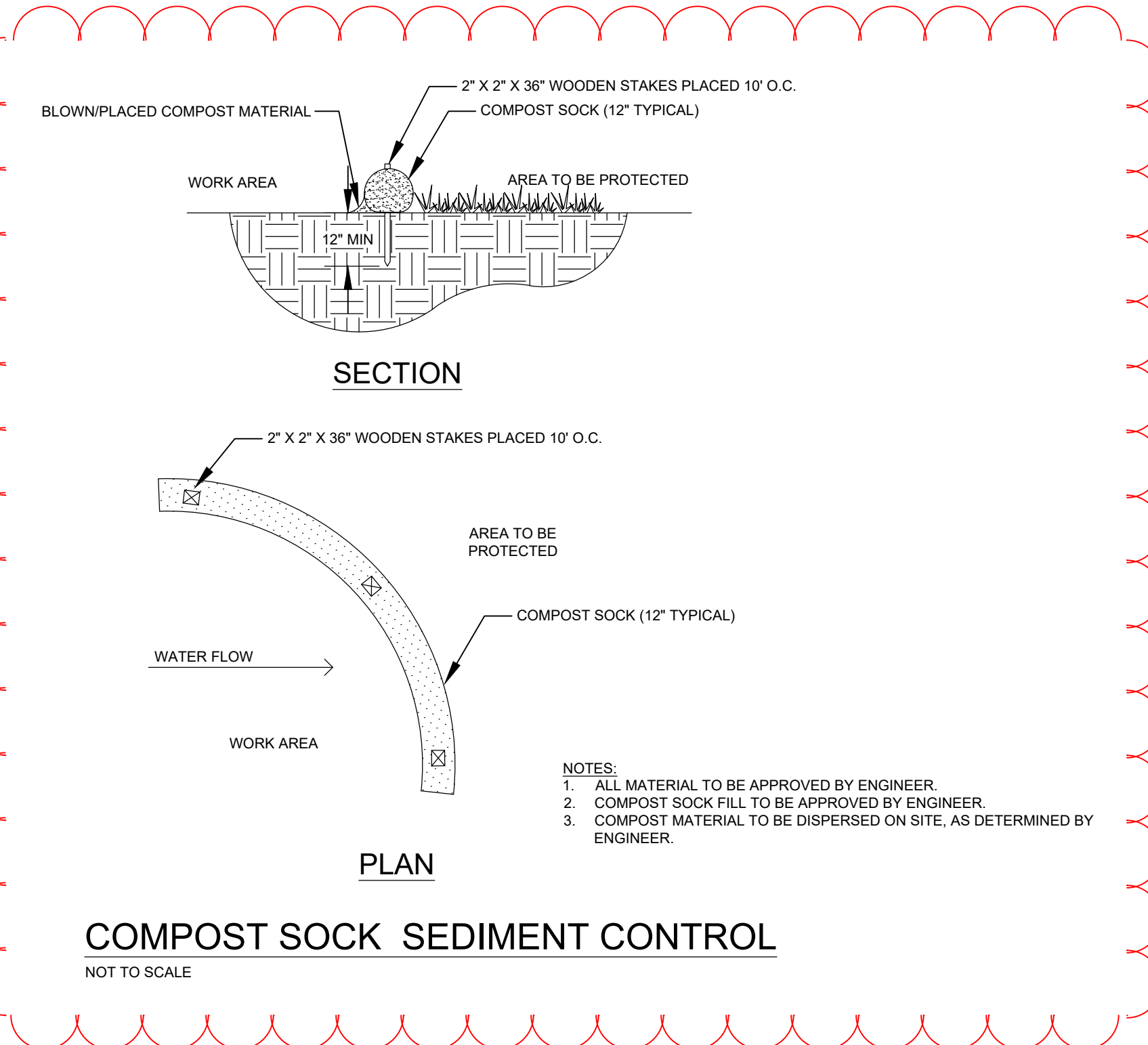

COMPOST SOCK SEDIMENT CONTROL
NOT TO SCALE

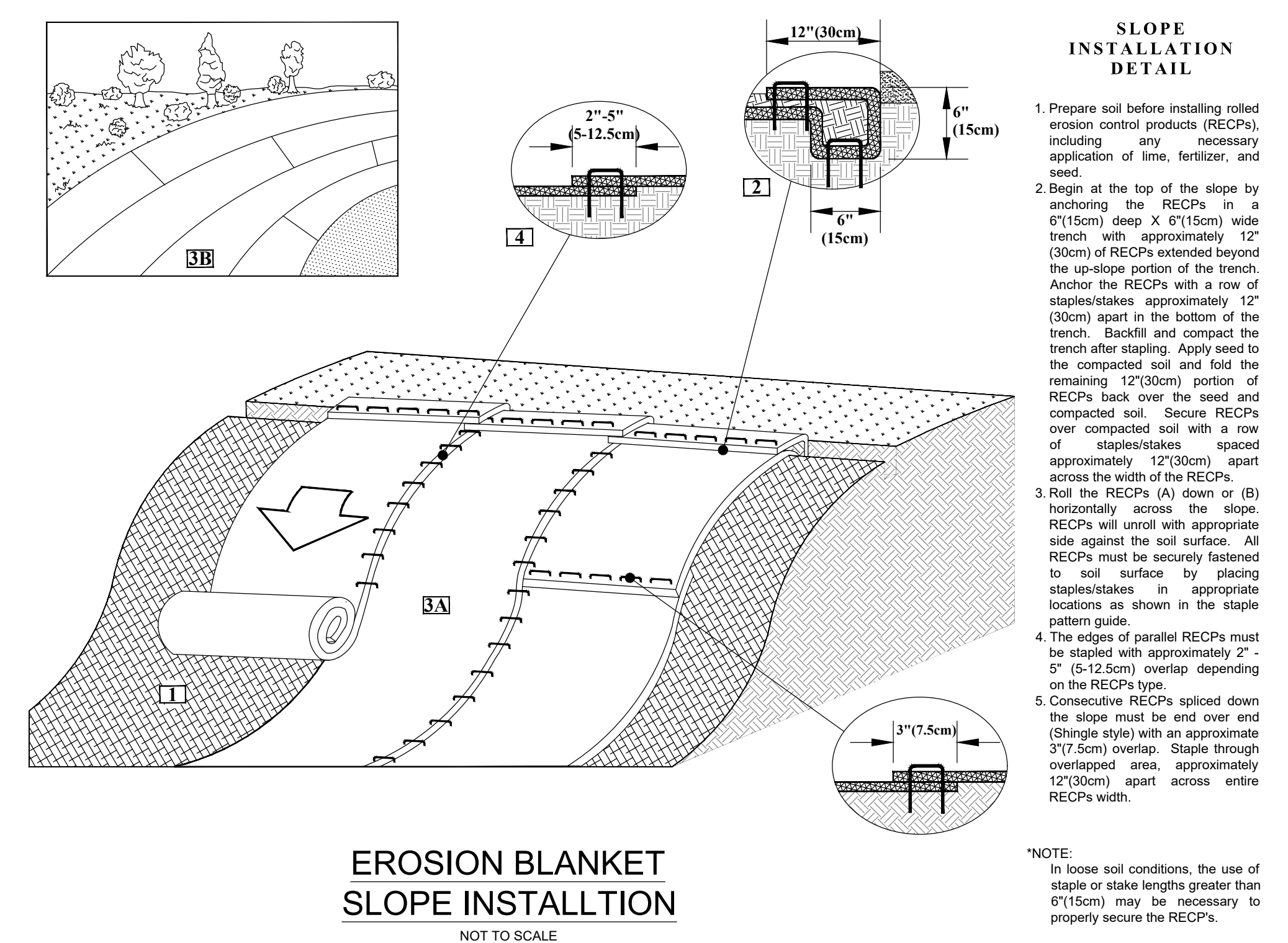

EROSION BLANKET SLOPE INSTALLTION
NOT TO SCALE

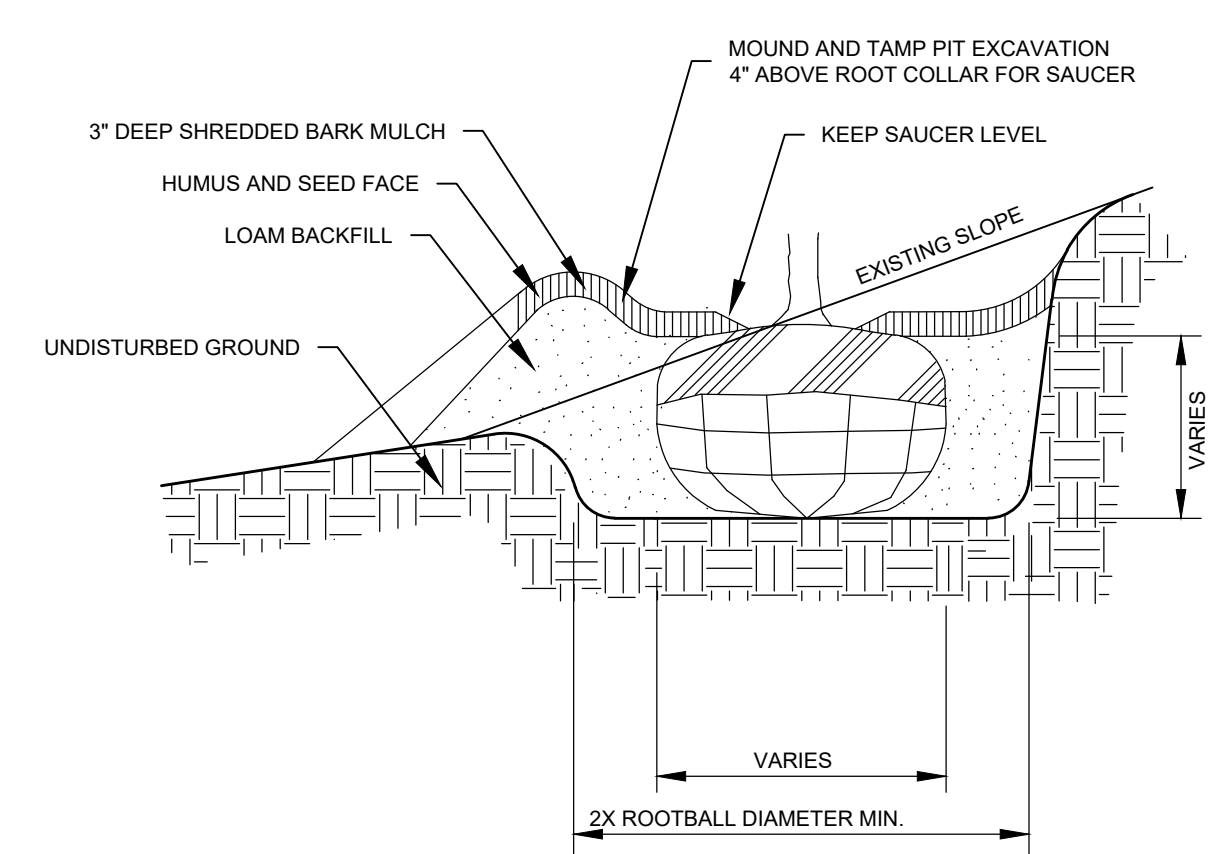

TYPICAL PLANTING PIT ON SLOPE 4:1 OR GREATER
NOT TO SCALE

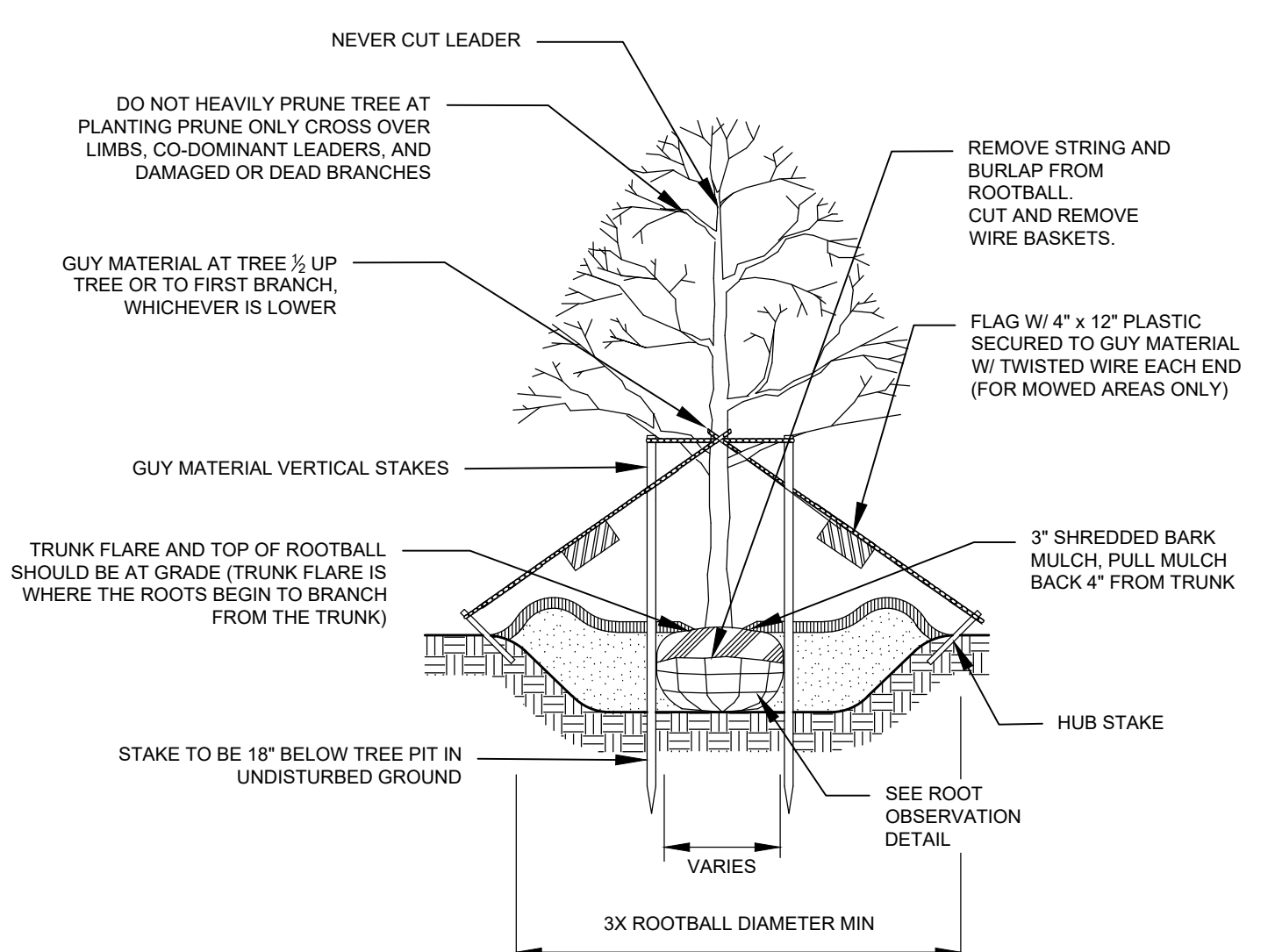

DECIDUOUS TREE PLANTING
NOT TO SCALE

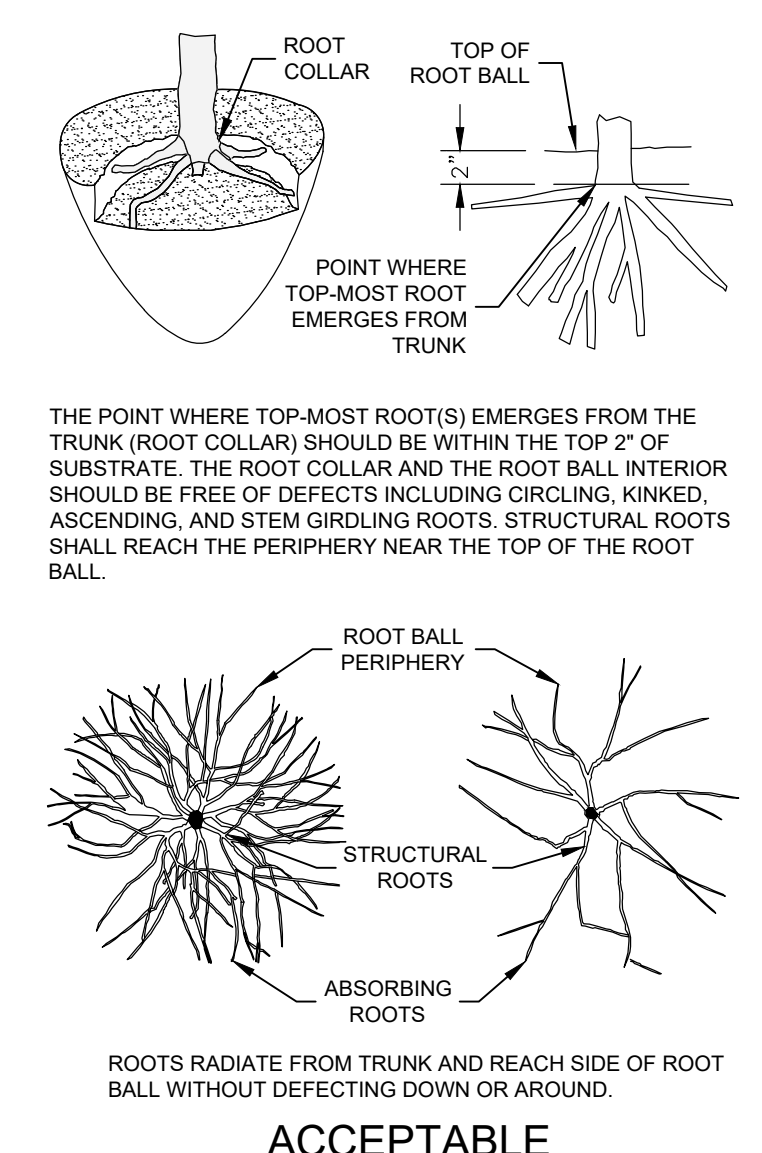

ROOT OBSERVATION
NOT TO SCALE

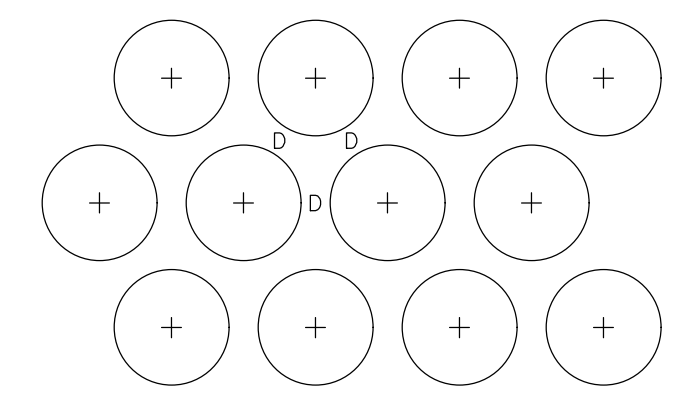

TYPICAL BED PLANT SPACING

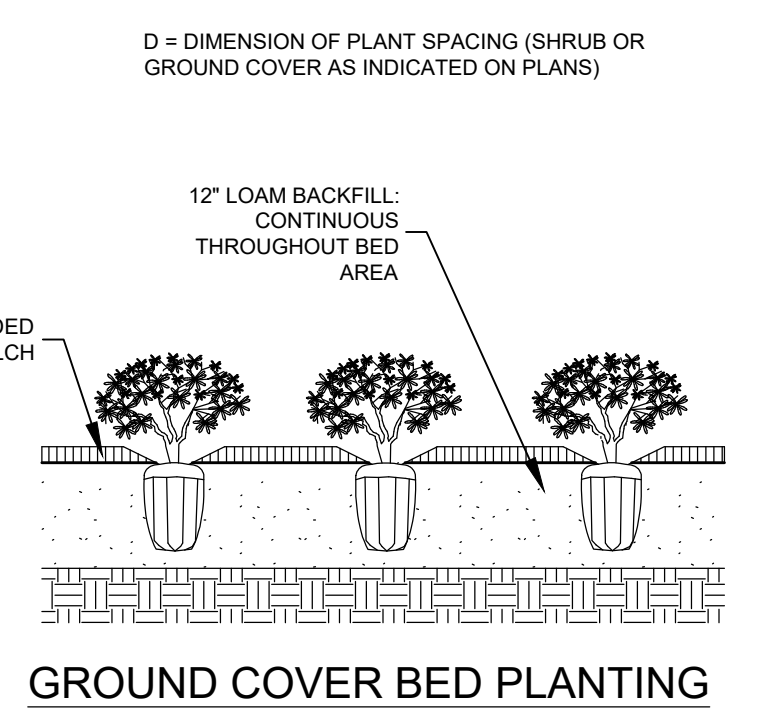

GROUND COVER INSTALLATION
NOT TO SCALE

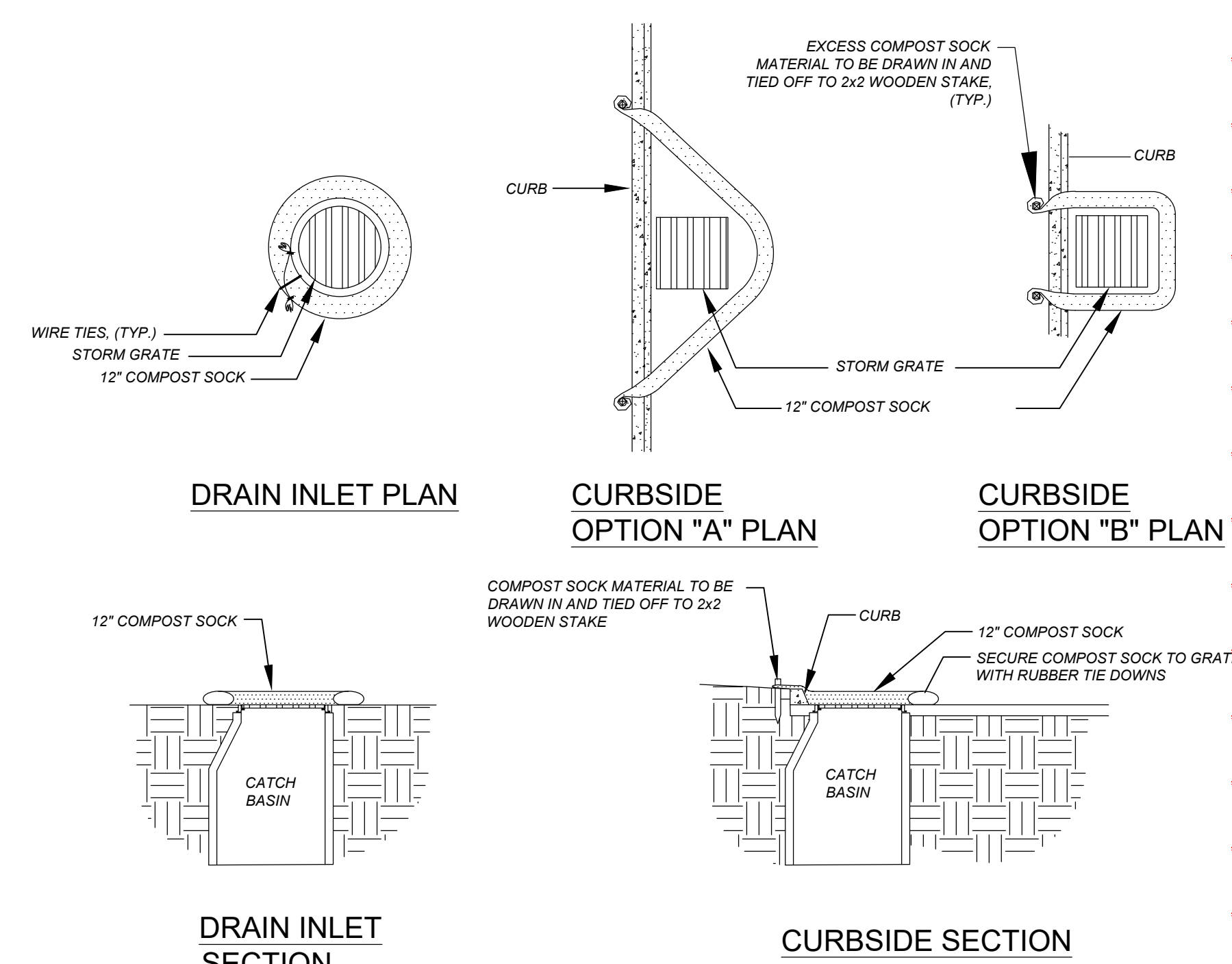

COMPOST SOCK INLET PROTECTION
NOT TO SCALE

REVISION HISTORY
1. RESPONSE TO CONSERVATION COMMISSION COMMENTS (04/24/2020)

Issued For
Permitting

ALL DOCUMENTS PREPARED BY WILCOX & BARTON, INC. ARE INSTRUMENTS OF SERVICE IN RESPECT OF THE PROJECT. THEY ARE NOT INTENDED OR REPRESENTED TO BE SUITABLE FOR REUSE BY OWNER OR OTHERS. ANY REUSE WITHOUT WRITTEN VERIFICATION OR ADAPTATION BY WILCOX & BARTON, INC. FOR THE SPECIFIC PURPOSE INTENDED WILL BE AT OWNER'S SOLE RISK AND WITHOUT LIABILITY OR LEGAL EXPOSURE TO WILCOX & BARTON, INC. OWNER SHALL INDEMNIFY AND HOLD HARMLESS WILCOX & BARTON, INC. FROM ALL CLAIMS, DAMAGES, LOSSES AND EXPENSES ARISING OUT OF OR RESULTING THEREFROM.

Owner
P&D REALTY
109 REFLECTION DR
SANDWICH, MA

Site
D'AGOSTINO'S DELICATESSEN
1297 MASS. AVE.
ARLINGTON, MA

Map/Block/Lot: 59/1/10D

Drawing Title
Construction & Erosion Control Details

Scale	N.T.S.	Date	03/04/2020
Drafted By	RSR	Project Mgr	RWB
Checked By	DLF	Project Number	PDRE0001

Sheet Number
C5.1